

TECHNICAL DATA INCLUDED IN THIS BROCHURE MAY BE CHANGE FROM TIME TO TIME DUE TO THE PRODUCT IMPROVEMENTS UNDERTAKES BY THE MANUFACTURER. THE COMPANY RESERVES THE UNCONDITIONAL RIGHTS TO IMPLEMENT SUCH CHANGES WITHOUT REFERENCE TO THIRD PARTIES.



The advertisement for Hanthing Water pumps features a blue and white color scheme. On the left is the Hanthing logo, a stylized blue 'S' shape above the word 'Hanthing' in blue. To the right of the logo is a collage of images showing various pump models and components. A large yellow diagonal banner across the center reads 'Water pump'. To the right of the banner, four blue boxes list pump types: 'Inline', 'Split case', 'Multi stage', and 'End suction'. At the bottom, the website 'www.hanthing.com' is displayed in white on a blue background.

Hanthing

Water pump

Inline
Split case
Multi stage
End suction

www.hanthing.com



The advertisement for Exthin Air Compressors features a black and yellow color scheme. On the left is the Exthin logo, a stylized yellow 'X' shape above the word 'Exthin' in yellow. To the right of the logo is a collage of images showing various compressor models and components. A large yellow diagonal banner across the center reads 'Air Compressor'. To the right of the banner, three black boxes list compressor types: 'Portable', 'Screw', and 'Piston'. At the bottom right is a large image of a blue and silver industrial compressor unit. At the top, the website 'www.exthin.com' is displayed in white on a black background.

www.exthin.com

Exthin

Air Compressor

Portable
Screw
Piston

ShangHai HanThing pump Co.,ltd
Website: www.hanthing.com
Address: NO.566, Tongli road, songjiang district, Shanghai, China
Mobile: +86-021-56550238
Email: sales@hanthing.com



国家产品质量免检 | 中国著名品牌

JQ系列

GN'Series'JUW i a 'Di a d



GdYVZjVWh]cb

型号 Modle	功率 power(kw)	转速 Speed(r/min)	抽气速率 Speed of airsuction(m3/h)	极限真空 U1timate vacum(-Mpa)	进排气口孔径 Inlet and outlet aperture(inch)	补水孔口径 Water hole diameter(inch)
SZ-0.3	0.75	2820	20	0.096	G1"	G1/2"
SZ-0.8	1.5	2840	40	0.096	G1"	G1/2"
SZ-1	2.2	2840	60	0.096	G1"	G1/2"
SZ-1.5	3	2870	90	0.096	G11/2	G1/2"
SZ-2	4	2890	120	0.096	G11/2	G1/2"
SZ-3A	5.5	1440	180	0.096	G2"	G1/2"
SZ-4.5	7.5	1440	270	0.096	G2"	G1/2"
SZ-6	11	1460	360	0.096	Φ66-Φ130-4Φ14	G1/2"

8]Ya Ybg]cb`8fUk]b[

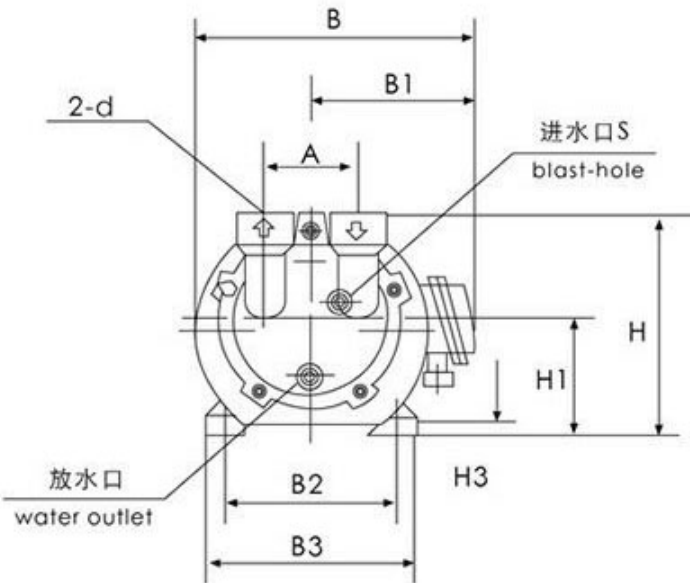
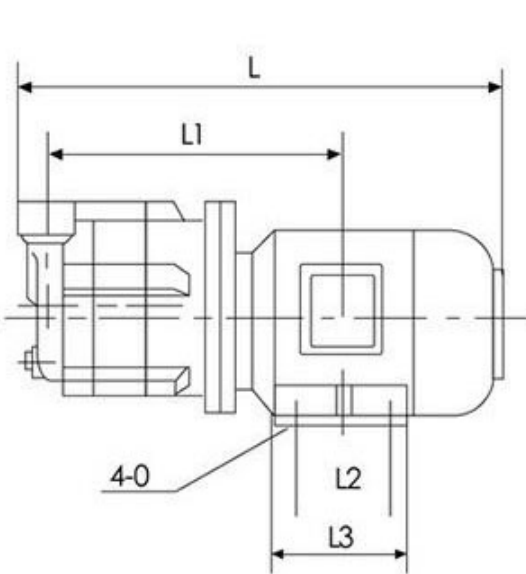

型号 Model	A	L	L1	L2	L3	B	B1	B2	B3	H	H1	H2	d	S	Φ
SZ-0.3	80	414	233	100	134	255	155	125	164	184	80	12	G1"	G1/2"	10
SZ-0.8	80	442	260	100	130	255	155	140	180	194	90	12	G1"		10
SZ-1	80	492	290	125	160	255	155	140	180	194	90	12	G1"		10
SZ-1.5	110	519	293	140	180	305	180	160	205	217	100	15	G11/2"		12
SZ-2	110	563	327	140	180	315	190	190	245	237	112	15	G11/2"		12
SZ-3A	160	640	364	140	205	370	210	216	280	320	132	18	G2"		12
SZ-4	160	710	384	178	240	370	210	216	280	320	132	18	G2"		12
SZ-6	190	822	463	210	275	455	255	254	330	412	160	22	法兰式4- G1/4 Φ130		19