

TECHNICAL DATA INCLUDED IN THIS BROCHURE MAY BE CHANGE FROM TIME TO TIME DUE TO THE PRODUCT IMPROVEMENTS UNDERTAKES BY THE MANUFACTURER. THE COMPANY RESERVES THE UNCONDITIONAL RIGHTS TO IMPLEMENT SUCH CHANGES WITHOUT REFERENCE TO THIRD PARTIES.



The banner features the Hanthing logo on the left, which consists of a stylized blue 'S' shape above the word 'Hanthing' in blue. To the right of the logo is a collage of various pump models and components. A large, diagonal yellow banner with the text 'Water pump' in blue runs across the center. To the right of this banner, four blue boxes list pump types: 'Inline', 'Split case', 'Multi stage', and 'End suction'. At the bottom, a blue bar contains the website 'www.hanthing.com' in white. The collage also includes the phrases 'QUALITY CREATES VALUE' and 'INNOVATION SHAPES THE FUTURE'.

**Hanthing**

**Water pump**

Inline  
Split case  
Multi stage  
End suction

[www.hanthing.com](http://www.hanthing.com)



The banner features the Exthin logo on the left, which consists of a stylized yellow 'X' shape above the word 'Exthin' in yellow. To the right of the logo is a collage of various compressor models and components. A large, diagonal yellow banner with the text 'Air Compressor' in black runs across the center. To the right of this banner, three black boxes list compressor types: 'Portable', 'Screw', and 'Piston'. At the bottom, a black bar contains the website 'www.exthin.com' in white. The collage also includes the phrases 'QUALITY CREATES VALUE' and 'INNOVATION SHAPES THE FUTURE'.

**Exthin**

**Air Compressor**

Portable  
Screw  
Piston

[www.exthin.com](http://www.exthin.com)

ShangHai HanThing pump Co.,ltd  
Website: [www.hanthing.com](http://www.hanthing.com)  
Address: NO.566, Tongli road, songjiang district, Shanghai, China  
Mobile: +86-021-56550238  
Email: [sales@hanthing.com](mailto:sales@hanthing.com)



国家产品质量免检 | 中国著名品牌

# DL系列立式多级泵

DL Series Vertical Multi-stage Pump



# 目 录

## CONTENTS

<b>概 述</b> Overview	1
<b>结构说明</b> On structure	1
<b>DL型泵结构图</b> DL Type pump structure darwing	2
<b>结构说明</b> Description of structurf	3
<b>可供选择的材料和结构特性（订货时注明）</b> Selectable materials and structural characteristics(please note at order)	3
<b>泵的装配与拆卸</b> Assembly and disassembly	4
<b>DL型泵型谱图</b> DL Type pump atlas of style	5
<b>DL型泵性能曲线图</b> DL Type pump performance curve chart	6
<b>DL型泵性能参数及外形安装尺寸图表</b> Performance data and installation drawing table	7
<b>泵的几种安装方法</b> Several ways of installation	26
<b>泵附件图及其尺寸表</b> Fittings drawing and dimension table	27
<b>泵基础图及其联接尺寸</b> Basic drawing and link dimension	27

## 概述 Overview

- 1、DL系列泵是立式、单吸、多级、分段式离心泵，输送清水及物理化学性质类似于水的85℃以下的液体之用。
- 2、泵为立式安装，具有结构紧凑、噪声低、占地面积小等特点，主要用于城镇供水及集中供热系统。
- 3、泵型号意义：

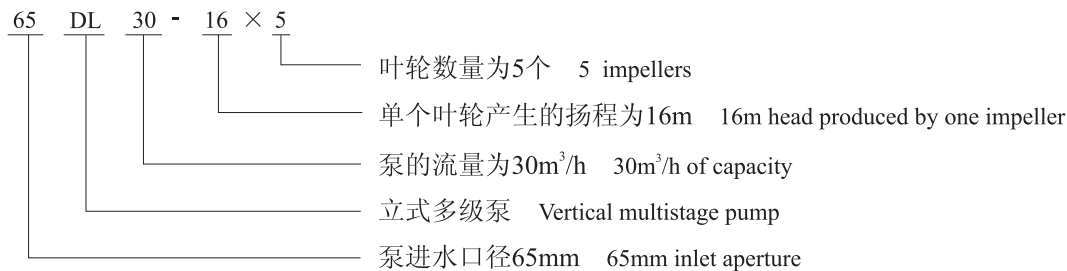

- 4、本系列泵所执行的技术标准是：JB/TQ809-89《立式多级泵型式与基本参数》、GB5659-85《多级离心泵技术条件》。
- 5、泵的旋转方向：从电机端往下看，泵为逆时针方向旋转。

- 1.DL series pumps are vertical, single suction, multistage, sectional and centrifugal ones and used for transporting pure water and the liquids below 85°C and with the physical and chemical natures similar to water's.
- 2.Vertically mounted, of a compact structure, low noise, small occupied land etc, features and mainly used for the water supply and the centralized heat supply system in cities.
- 3.Model meaning:

- 4.The technical standard executed for this series pumps is: JB/TQ809-89(Vertical multistage pump model and basic parameters),GB5659-85(Technical conditions for multistage centrifugal pumps).
- 5.Rotating direction of pump:CCW as viewed downward from the motor.

## 结构说明 On structure

- 1、DL型泵为立式结构，其吸入口位于进水段上（泵的下部），吐出口位于出水段上（泵的上部），均呈水平方向布置。可根据使用扬程的需要增减水泵级数。根据安装使用不同，进出口夹角可选用0°、90°、180°、270°四个方位（见下图），以调整吐出口的安装位置（若无特别说明，本公司将按进出口夹角180°出厂）。

- 1.Model DL pump is vertically structured,its suction port is located on the inlet section(lower part of pump), spitting port on the output section(upper part of pump), both are horizontally positioned. The number of stages can be increased or decreased per the required head at use. There are four included angles of 0°,90°,180°and 270°available for selecting per different installations and uses in order to adjust the mounting position of the spitting port (the one when ex-works is 180° if no special note is given).

从电机端看，出口相对进口位置示意图  
Schematic diagram of the position of the outlet relative to the inlet, as viewed from the motor

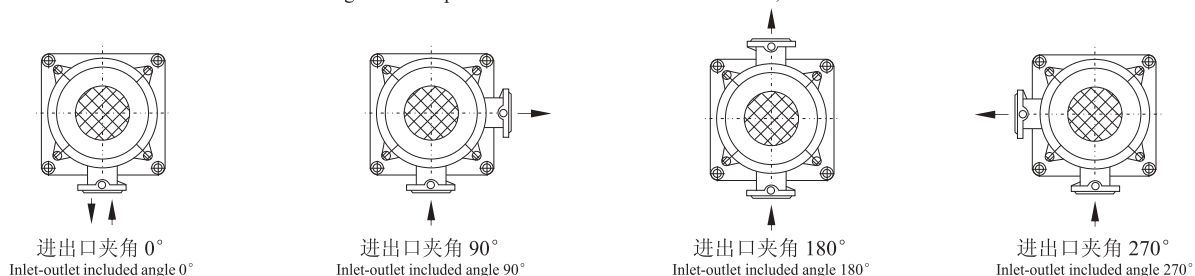



## DL型泵结构图 DL type pump structure drawing

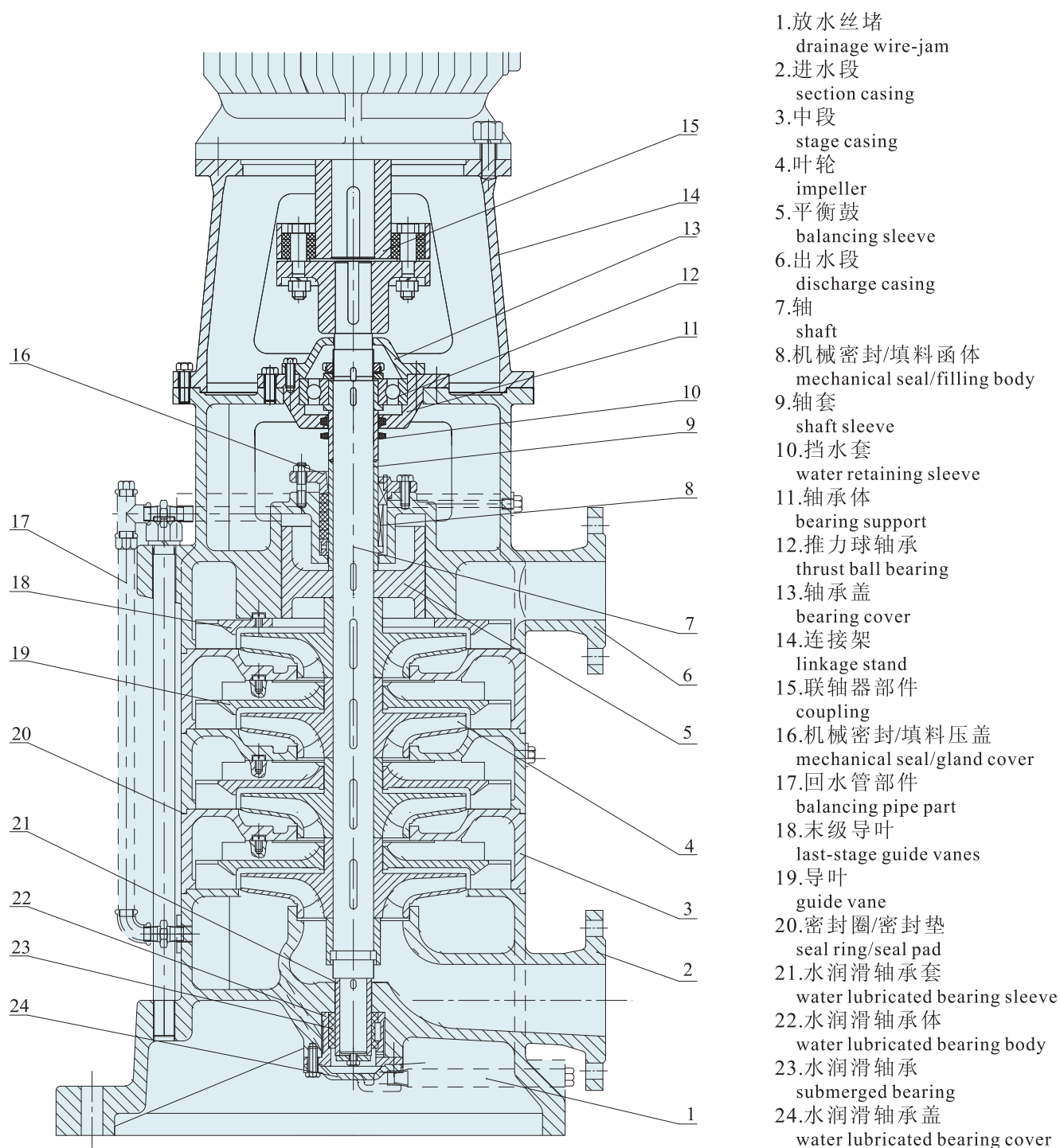

2、DL型泵的主要零件有：进水段、中段、出水段、叶轮、导叶、出水段导叶、轴、轴承、轴套、平衡鼓、连接架等。

2.1 进水段、中段、出水段、导叶、出水段导叶均为铸铁制成，共同形成泵的工作室。

2.2 叶轮为铸铁制成，液体沿轴向单侧进入，由于叶轮前后受压不等，会存在轴向力，此轴向力绝大部分由平衡鼓来平衡，而小部分残余轴向力由轴上端的球轴承来承受。

2.3 轴为优质碳钢制成，中间装有叶轮、平衡鼓和轴套，用键和轴套螺母固定在轴上组成为转子部件。轴的一端装有下列轴套，与塑料轴承相配合，另一端装有球轴承，借以支承转子部件。其上安装联轴器部件与电机直接连接。

2.4 轴封不仅能用软填料，而且可与机械密封互换，当用软填料密封时，轴套磨损后可以更换。

轴封为机械密封时，采用平衡室内的压力水进行润滑和冷却。

轴封为填料密封时，出水段上的 3/8" 软管接头，用于把填料体中漏出的水通过软管排放到地沟里，以保持水泵周围场地的整洁。

2.5 泵上端轴承采用二硫化钼润滑脂润滑。

2. Major parts of the pump: inlet, middle and outlet sections, impeller, guide vane, guide vane on outlet section, shaft, bearing, shaft sleeve, balance drum and sleeve, link stand etc.

2.1 The inlet, middle and outlet sections, guide vane, guide vane on outlet section are all made of cast iron and mutually form the working room of the pump.

2.2 The impeller is made of cast-iron, Liquids go in from one side along with the shaft and an axial force may exist because unequal pressures on both front and back of the impeller. Most of the force is made balanced by the balance drum while its residual is supported by the ball bearing on the upper end of the shaft.

2.3 The shaft is made of qualified carbon steel and in its middle the impeller, balance drum and shaft sleeve are mounted, which are fixed with pins and shaft sleeve nuts on the shaft to form the rotor. On one end of the shaft a lower shaft sleeve is mounted, which is fitted with the plastic bearing, and on the other the ball bearing is mounted to support the rotor and on the top of it a clutch is mounted and directly connected to the motor.

2.4 Both balance drum and sleeve form the balance device of the pump and can be replaced when worn out.

2.5 The shaft seal can not only use soft filling but also be changed with mechanical seal, when using soft filling, the shaft sleeve can be replaced when worn out and, when as the mechanical seal, the pressure water inside of the balance room is used for lubrication and cooling.

When as the filling seal, the 3/8" flexible union on the outlet section is used through the flexible pipe to drain the water leaked from the filling body to the underground ditch to keep the place around the pump clean.

2.6 The bearing on the upper end of the pump uses molybdenum disulfide grease for lubrication.

## 可供选择的材料和结构特性（订货时注明）

## Selectable materials and structural characteristics(please note at order)

1 轴封形式  
shaft seal form

- 填料密封  
filling seal
- 机械密封  
mechanical seal

2 轴承  
bearing

- 国产优质轴承  
domestic qualified bearing
- 进口低噪音轴承  
imported low noise bearing

3 叶轮  
impeller

- 铸铁HT200叶轮  
cast-iron HT200 impeller
- ZCuSn10Zn2铜合金叶轮  
ZCuSn10Zn2 copper alloy impeller

4 轴  
shaft

- 45#钢轴  
45# steel shaft
- 不锈钢轴  
stainless steel shaft

## 泵的装配与拆卸 Assembly and disassembly

### 1. 部件组装:

- 1.1 将防砂管插入进水段孔内。将水中轴承装入水中轴承套内，并装在进水段上。
- 1.2 将平衡套压在出水段上，并装上出水段导叶。
- 1.3 在填料体上拧好双头螺柱，装上填料和填料压盖。
- 1.4 装好回水管部件。
- 1.5 在轴上嵌上短键，将下轴套穿入装上，并用挡圈和螺母压紧固定之。
- 1.6 将电机联轴器装到电机上。

### 2. 总装:

- 2.1 将轴穿入进水段，并将键放在轴键槽内，顺轴装上第一级叶轮。
- 2.2 将已装好导叶的中段顺轴装在出水段上，再装上第二级键、叶轮，重复以上步骤，直至将所有键、叶轮和中段装完。
- 2.3 将出水段装在中段上，装上平衡鼓。
- 2.4 在轴上嵌上短键，装上轴套。轴封为机械密封时，应连同轴套装好，然后穿在轴上，并用密封压盖固定之。轴封为填料时，先装好轴套，再上紧填料，并用填料压盖固定好。
- 2.5 装入挡水套，将轴承盒装在填料体上，并用螺栓紧固。
- 2.6 装上球轴承，并套上轴承挡板，再用螺母紧固。
- 2.7 往轴承盒内注入适量黄油，并将纸垫套在轴承盖上，将轴承盖装到轴承盒上，并用螺栓紧固，再装上泵联轴器，并用手盘动转子，检查转子是否灵活。
- 2.8 将联接架装在填料体上，用螺母紧固之，并在联接架上安装好电机。
- 2.9 在泵上装好回水管部件。
- 2.10 装上联轴器柱销和填料。装好放气旋塞、油杯和所有的丝堵。

### 3. 泵的拆卸按上述相反步骤进行。

### 1.Assembly of parts:

- 1.1 Insert the sand-proof tube into the hole on the inlet section. Put the water bearing into the water bearing sleeve and then in the inlet section.
- 1.2 Press the balance sleeve on both and outlet sections and mount the guide vane on the outlet section.
- 1.3 Tighten the stud on the filling body and place the filling and the filling gland.
- 1.4 Mount the back water pipe.
- 1.5 Inlay the short key on the shaft and put the lower shaft sleeve on, then fix it with the retaining ring and nuts.
- 1.6 Mount the clutch on the motor.

### 2Assembly:

- 2.1 Insert the shaft into the inlet section and put the key into the key slot on the shaft and mount the first-stage impeller on along with the shaft.
- 2.2 Mount the middle section already mounted with the guide vane on the outlet section along with the shaft, then the secondstage key and impeller, repeat these steps till all keys, impellers and middle sections mounted.
- 2.3 Mount the outlet section on the middle one, the balance drum.
- 2.4 Inlay the short key on the shaft and put on the sleeve. When as a mechanical seal, the shaft seal has to be put on the sleeve, then on the shaft and fixed with a seal gland. In case a packing is used as the axis seal, first place the muff, then the packing and fix it with the packing gland.
- 2.5 Put the water retaining sleeve in. Mount the bearing case on the filling body and tighten it with a bolt.
- 2.6 Mount the ball bearing on and put a bearing baffle on it, then fix with nuts.
- 2.7 Add a proper amount of grease into the bearing case, put a paper pad on the bearing cover, then mount the bearing cover on the case and fix it with a bolt. Then mount the pump clutch and turn the rotor with hand to check if it turns flexibly.
- 2.8 Mount the linkage stand on the filling body and fix it with nuts then mount the motor on the stand.
- 2.9 Mount the back water pipe on the pump.
- 2.10 Mount the postal pin on the clutch and fill the filling. Mount the airbleed cock, oil cup and all wire-jams.

### 3.Take reversed steps to disassemble.

### 承压件试验压力

- 1、泵进水段做静水压试验，保持压力为0.6MPa，保压时间不少于5分钟，保证无泄漏、渗漏、冒汗等缺陷现象。
- 2、泵的中段与出水段组装在一起做静水压试验，保持压力为允许进口压力与最高级数泵的工作压力之和的1.5倍，保压时间不少于5分钟，保证无泄漏、渗漏、冒汗等缺陷现象。通常于允许进口压力为0.4MPa。

### Test pressure of pressure parts

1. The pump suction hydrostatic test, maintain pressure is 0.6MPa, pressure time not less than 5 minutes, to ensure no leakage, leakage, sweating and so on defect phenomenon.
2. The pump and the middle section of the water outlet segment assembled together to do the hydrostatic test pressure, keeping the pressure is 1.5 times the allowable inlet pressure and the most senior of the number of pump pressure of work and Paul pressure time not less than 5 minutes, to ensure no leakage, leakage, sweating and so on defect phenomenon. Usually to allow the inlet pressure 0.4MPa.

## DL型泵型谱图 DL type pump atlas of style

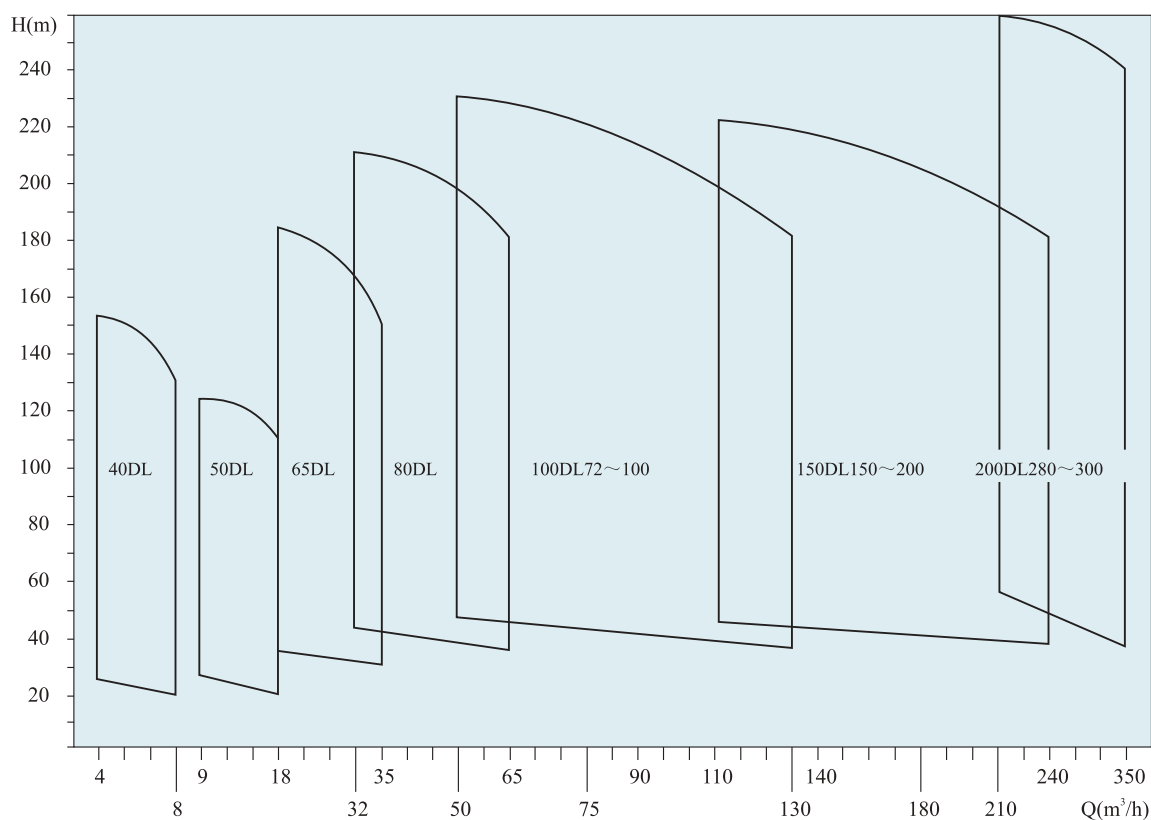

## DL型泵性能曲线图 DL type pump performance curve chart

40DL×2~40DL×12

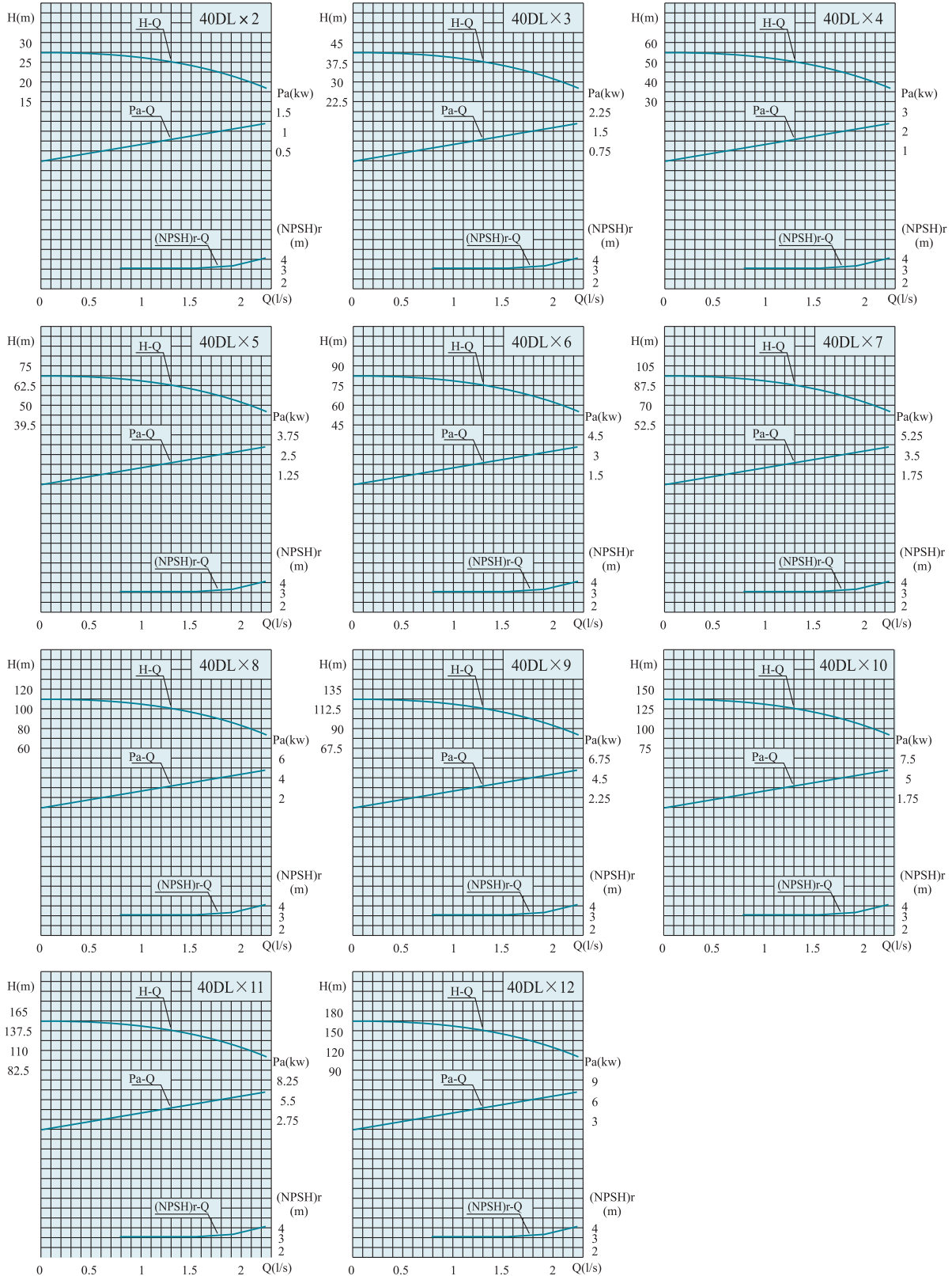

## DL型泵性能参数及外形安装尺寸图表 Performance data and installation drawing table

泵型号 Pump model	级数 Series	流量 Capacity		扬程 Head (m)	功率 Power (kW)	转速 Speed (r/min)	必需汽蚀量 (NPSH) <sub>r</sub> (m)	重量 Weight (kg)
		(m³/h)	(L/s)					
40DL6-12	2	4.2 6 7.2	1.17 1.67 2	26 23.6 22	1.5	1480	3 3.2 3.6	230
	3	4.2 6 7.2	1.17 1.67 2	39 35.4 33	2.2	1480	3 3.2 3.6	280
	4	4.2 6 7.2	1.17 1.67 2	52 47.2 44	3	1480	3 3.2 3.6	300
	5	4.2 6 7.2	1.17 1.67 2	65 59 55	4	1480	3 3.2 3.6	330
	6	4.2 6 7.2	1.17 1.67 2	78 70.8 66	4	1480	3 3.2 3.6	350
	7	4.2 6 7.2	1.17 1.67 2	91 82.6 77	5.5	1480	3 3.2 3.6	400
40DL6-12	8	4.2 6 7.2	1.17 1.67 2	104 94.4 88	5.5	1480	3 3.2 3.6	415
	9	4.2 6 7.2	1.17 1.67 2	117 106 99	7.5	1480	3 3.2 3.6	450
	10	4.2 6 7.2	1.17 1.67 2	130 118 110	7.5	1480	3 3.2 3.6	470
	11	4.2 6 7.2	1.17 1.67 2	143 130 121	7.5	1480	3 3.2 3.6	490
	12	4.2 6 7.2	1.17 1.67 2	156 142 132	11	1480	3 3.2 3.6	560
	12	4.2 6 7.2	1.17 1.67 2	156 142 132	11	1480	3 3.2 3.6	560

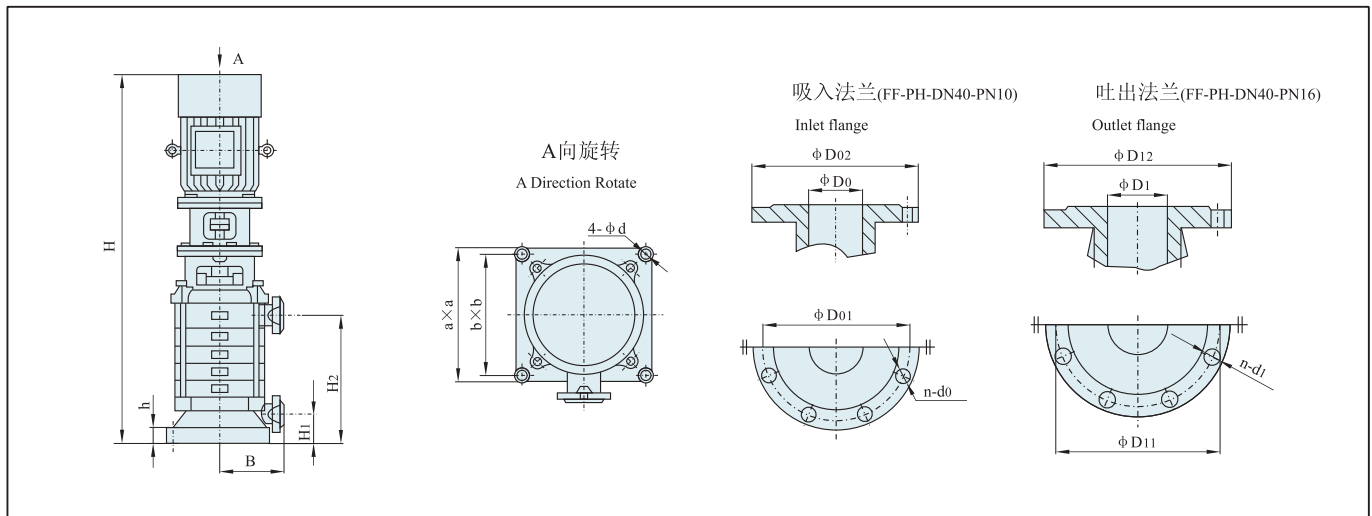

泵型号 Pump model	级数 Series	外形尺寸 Figure dimension		安 装 尺 寸 Installation dimension						吸 入 法 兰 Inlet flange				吐 出 法 兰 Outlet flange			
		H	a×a	H <sub>1</sub>	H <sub>2</sub>	h	B	b×b	4-φd	D <sub>0</sub>	D <sub>01</sub>	D <sub>02</sub>	n-d <sub>0</sub>	D <sub>1</sub>	D <sub>11</sub>	D <sub>12</sub>	n-d <sub>1</sub>
40DL6-12	2	968	345×345	112	282	55	225	300×300	φ 18	40	110	150	4-φ 17.5	40	110	150	4-φ 17.5
	3	1073	345×345	112	342	55	225	300×300	φ 18	40	110	150	4-φ 17.5	40	110	150	4-φ 17.5
	4	1133	345×345	112	402	55	225	300×300	φ 18	40	110	150	4-φ 17.5	40	110	150	4-φ 17.5
	5	1213	345×345	112	462	55	225	300×300	φ 18	40	110	150	4-φ 17.5	40	110	150	4-φ 17.5
	6	1273	345×345	112	522	55	225	300×300	φ 18	40	110	150	4-φ 17.5	40	110	150	4-φ 17.5
	7	1408	345×345	112	582	55	225	300×300	φ 18	40	110	150	4-φ 17.5	40	110	150	4-φ 17.5
	8	1468	345×345	112	642	55	225	300×300	φ 18	40	110	150	4-φ 17.5	40	110	150	4-φ 17.5
	9	1568	345×345	112	702	55	225	300×300	φ 18	40	110	150	4-φ 17.5	40	110	150	4-φ 17.5
	10	1628	345×345	112	762	55	225	300×300	φ 18	40	110	150	4-φ 17.5	40	110	150	4-φ 17.5
	11	1688	345×345	112	822	55	225	300×300	φ 18	40	110	150	4-φ 17.5	40	110	150	4-φ 17.5
	12	1833	345×345	112	882	55	225	300×300	φ 18	40	110	150	4-φ 17.5	40	110	150	4-φ 17.5



## DL型泵性能曲线图 DL type pump performance curve chart

50DL×2~50DL×10

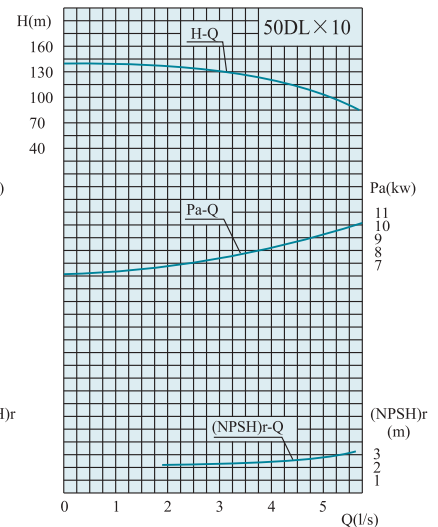
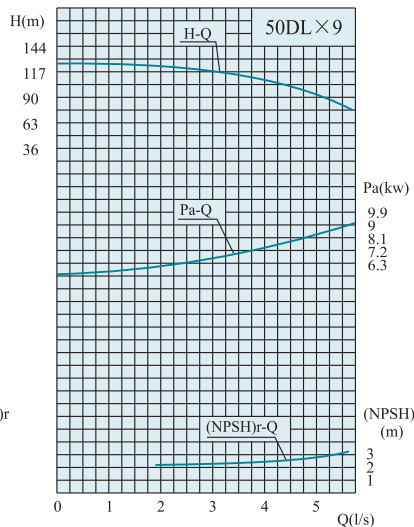
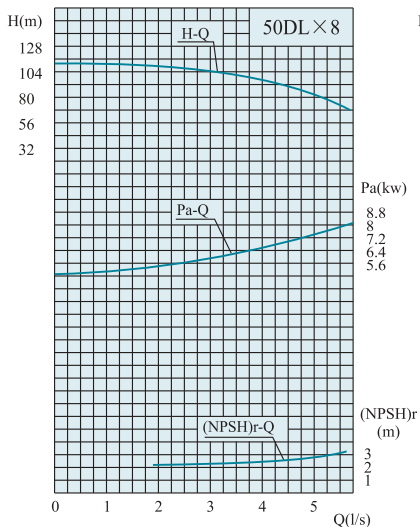
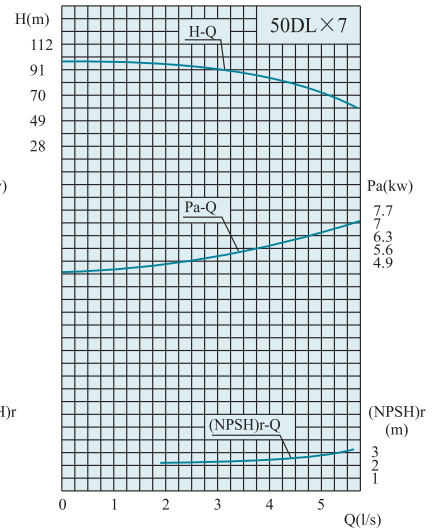
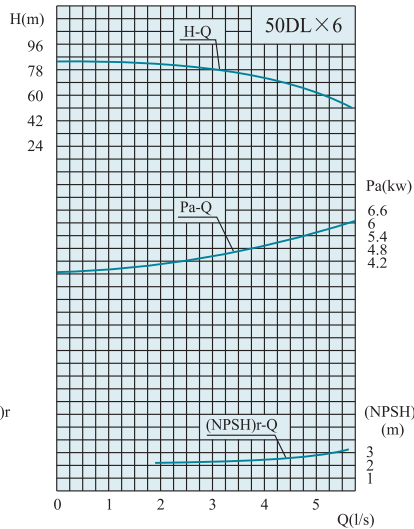
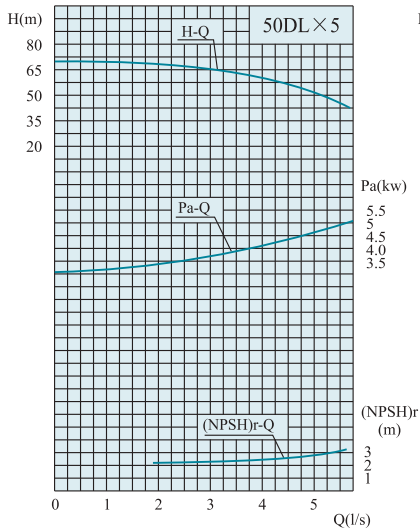
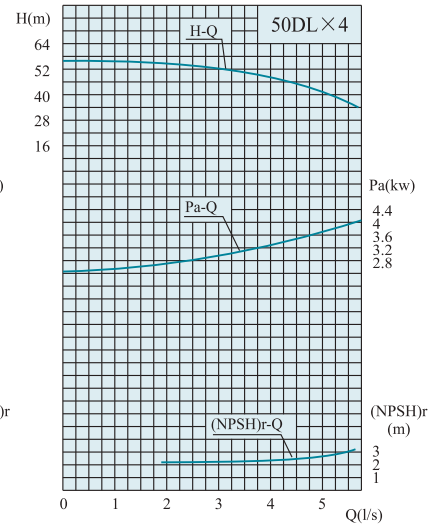
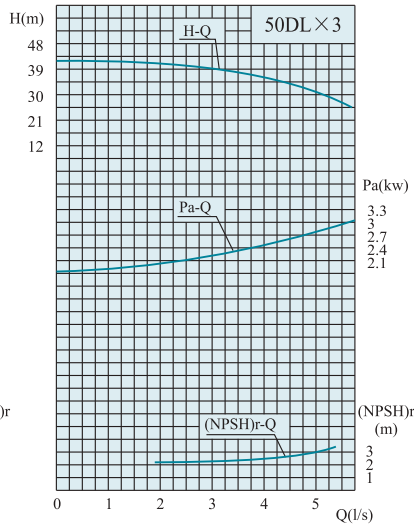
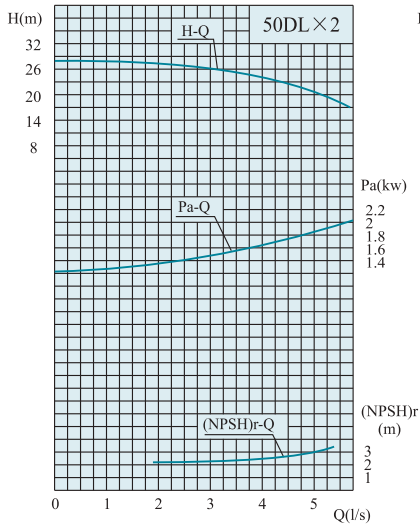

## DL型泵性能参数及外形安装尺寸图表 Performance data and installation drawing table

泵型号 Pump model	级数 Series	流量Capacity		扬程 Head (m)	功率 Power (kW)	转速 Speed (r/min)	必需汽蚀量 (NPSH) <sub>r</sub> (m)	重量 Weight (kg)
		(m³/h)	(L/s)					
50DL12-12.5	2	9 12.6 18	2.5 3.5 5	27 24.4 22	3	1480	2.6 2.7 3.2	235
	3	9 12.6 18	2.5 3.5 5	40.5 36.6 33	3	1480	2.6 2.7 3.2	255
	4	9 12.6 18	2.5 3.5 5	54 48.8 44	4	1480	2.6 2.7 3.2	285
	5	9 12.6 18	2.5 3.5 5	67.5 61 55	5.5	1480	2.6 2.7 3.2	330
	6	9 12.6 18	2.5 3.5 5	81 73.2 66	5.5	1480	2.6 2.7 3.2	350
50DL12-12.5	7	9 12.6 18	2.5 3.5 5	94.5 85.4 77	7.5	1480	2.6 2.7 3.2	380
	8	9 12.6 18	2.5 3.5 5	108 97.6 88	7.5	1480	2.6 2.7 3.2	405
	9	9 12.6 18	2.5 3.5 5	121.5 110 99	11	1480	2.6 2.7 3.2	470
	10	9 12.6 18	2.5 3.5 5	135 122 110	11	1480	2.6 2.7 3.2	490

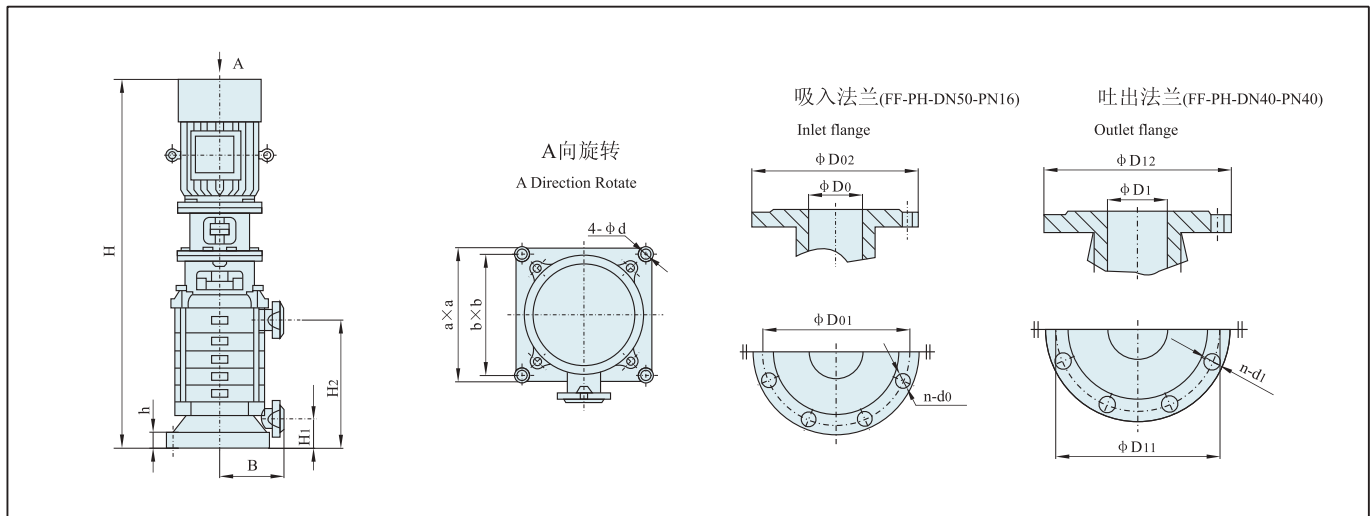

泵型号 Pump model	级数 Series	外形尺寸 Figure dimension		安 装 尺 寸 Installation dimension						吸 入 法 兰 Inlet flange				吐 出 法 兰 Outlet flange			
		H	a×a	H <sub>1</sub>	H <sub>2</sub>	h	B	b×b	4-φd	D <sub>0</sub>	D <sub>01</sub>	D <sub>02</sub>	n-d <sub>0</sub>	D <sub>1</sub>	D <sub>11</sub>	D <sub>12</sub>	n-d <sub>1</sub>
50DL12-12.5	2	1024	345×345	105	293	58	220	305×305	φ 18	50	125	165	4-φ 17.5	40	110	150	4-φ 17.5
	3	1092	345×345	105	361	58	220	305×305	φ 18	50	125	165	4-φ 17.5	40	110	150	4-φ 17.5
	4	1180	345×345	105	429	58	220	305×305	φ 18	50	125	165	4-φ 17.5	40	110	150	4-φ 17.5
	5	1323	345×345	105	497	58	220	305×305	φ 18	50	125	165	4-φ 17.5	40	110	150	4-φ 17.5
	6	1431	345×345	105	565	58	220	305×305	φ 18	50	125	165	4-φ 17.5	40	110	150	4-φ 17.5
	7	1499	345×345	105	633	58	220	305×305	φ 18	50	125	165	4-φ 17.5	40	110	150	4-φ 17.5
	8	1567	345×345	105	701	58	220	305×305	φ 18	50	125	165	4-φ 17.5	40	110	150	4-φ 17.5
	9	1725	345×345	105	769	58	220	305×305	φ 18	50	125	165	4-φ 17.5	40	110	150	4-φ 17.5
	10	1793	345×345	105	837	58	220	305×305	φ 18	50	125	165	4-φ 17.5	40	110	150	4-φ 17.5

## DL型泵性能曲线图 DL type pump performance curve chart

65DL×2~65DL×10

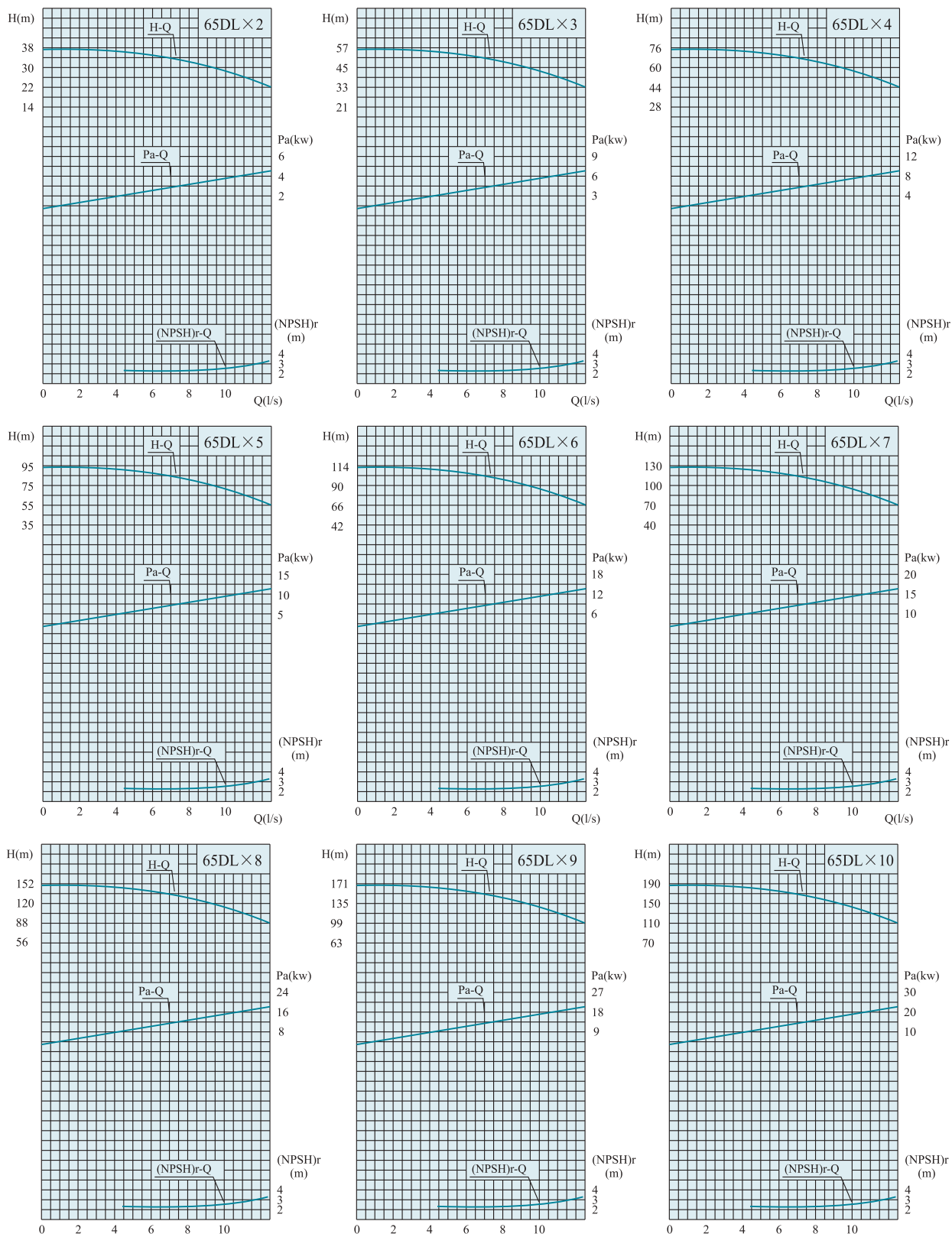

## DL型泵性能参数及外形安装尺寸图表 Performance data and installation drawing table

泵型号 Pump model	级数 Series	流量Capacity		扬程 Head (m)	功率 Power (kW)	转速 Speed (r/min)	必需汽蚀量 (NPSH) <sub>r</sub> (m)	重量 Weight (kg)
		(m³/h)	(L/s)					
65DL30-16	2	18	5	37	5.5	1480	2.41	380
		30	8.33	32			2.82	
		35	9.72	29			3.03	
	3	18	5	55.5	7.5	1480	2.41	450
		30	8.33	48			2.82	
		35	9.72	43.5			3.03	
	4	18	5	74	11	1480	2.41	540
		30	8.33	64			2.82	
		35	9.72	58			3.03	
	5	18	5	92.5	15	1480	2.41	600
		30	8.33	80			2.82	
		35	9.72	72.5			3.03	
65DL30-16	7	18	5	129.5	18.5	1480	2.41	730
		30	8.33	112			2.82	
		35	9.72	101.5			3.03	
	8	18	5	148	22	1480	2.41	795
		30	8.33	128			2.82	
		35	9.72	116			3.03	
	9	18	5	166.5	22	1480	2.41	840
		30	8.33	144			2.82	
		35	9.72	130.5			3.03	
	10	18	5	185	30	1480	2.41	965
		30	8.33	160			2.82	
		35	9.72	145			3.03	

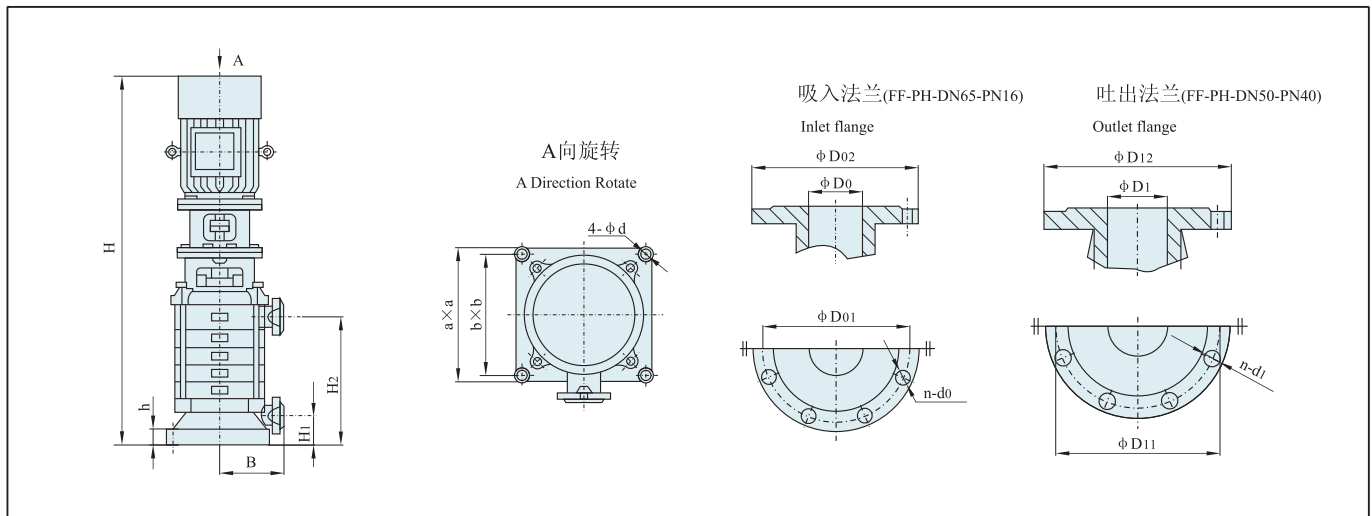

泵型号 Pump model	级数 Series	外形尺寸 Figure dimension		安装尺寸 Installation dimension						吸入法兰 Inlet flange				吐出法兰 Outlet flange			
		H	a×a	H <sub>1</sub>	H <sub>2</sub>	h	B	b×b	4-φd	D <sub>0</sub>	D <sub>01</sub>	D <sub>02</sub>	n-φd <sub>0</sub>	D <sub>1</sub>	D <sub>11</sub>	D <sub>12</sub>	n-φd <sub>1</sub>
65DL30-16	2	1217	430×430	167	364	45	260	370×370	φ26	65	145	185	4-φ17.5	50	125	165	4-φ17.5
	3	1337	430×430	167	444	45	260	370×370	φ26	65	145	185	4-φ17.5	50	125	165	4-φ17.5
	4	1522	430×430	167	524	45	260	370×370	φ26	65	145	185	4-φ17.5	50	125	165	4-φ17.5
	5	1647	430×430	167	604	45	260	370×370	φ26	65	145	185	4-φ17.5	50	125	165	4-φ17.5
	6	1727	430×430	167	684	45	260	370×370	φ26	65	145	185	4-φ17.5	50	125	165	4-φ17.5
	7	1832	430×430	167	764	45	260	370×370	φ26	65	145	185	4-φ17.5	50	125	165	4-φ17.5
	8	1952	430×430	167	844	45	260	370×370	φ26	65	145	185	4-φ17.5	50	125	165	4-φ17.5
	9	2032	430×430	167	924	45	260	370×370	φ26	65	145	185	4-φ17.5	50	125	165	4-φ17.5
	10	2177	430×430	167	1004	45	260	370×370	φ26	65	145	185	4-φ17.5	50	125	165	4-φ17.5

## DL型泵性能曲线图 DL type pump performance curve chart

80DL×2~80DL×10

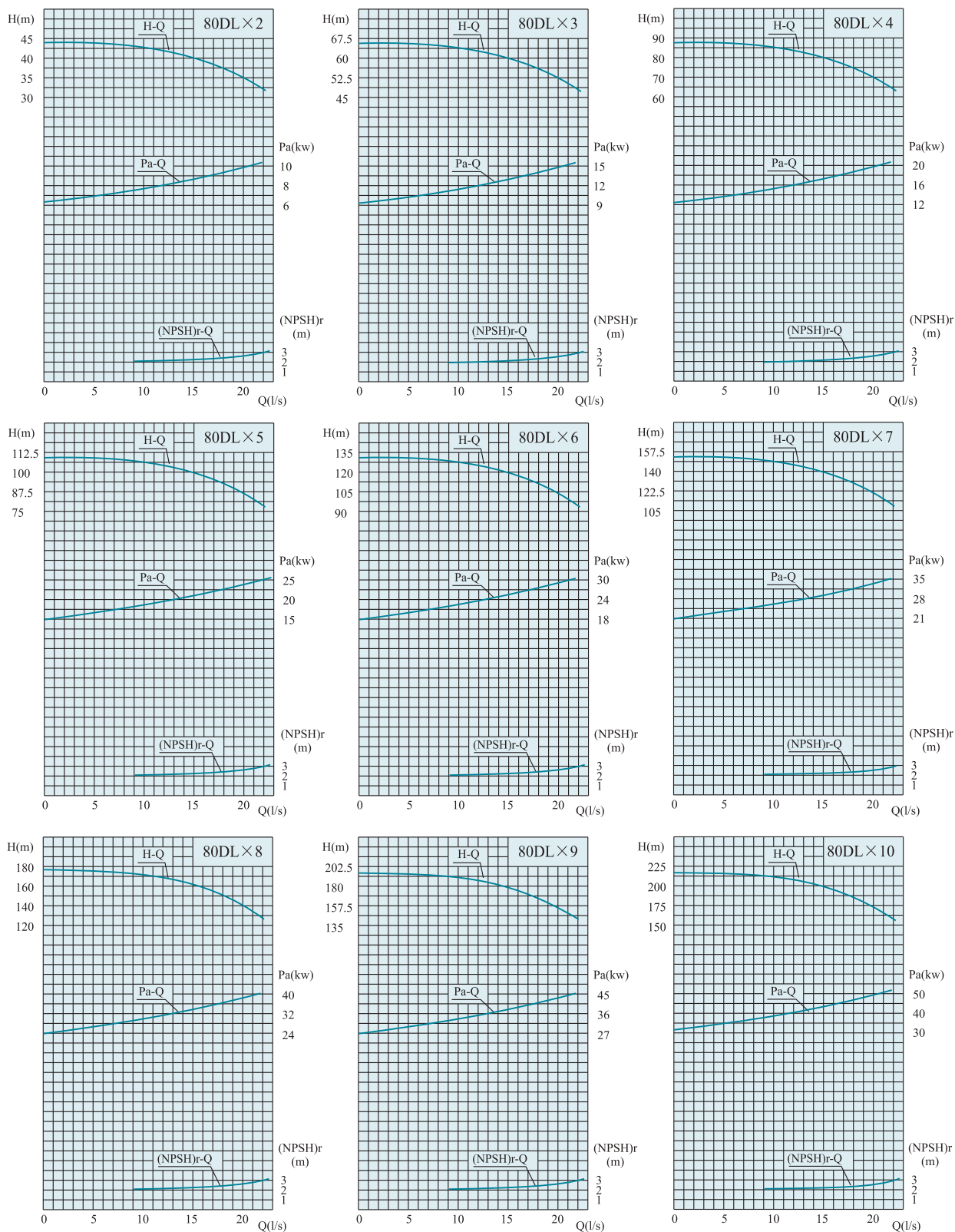

## DL型泵性能参数及外形安装尺寸图表 Performance data and installation drawing table

泵型号 Pump model	级数 Series	流量Capacity		扬程 Head (m)	功率 Power (kW)	转速 Speed (r/min)	必需汽蚀量 (NPSH) <sub>r</sub> (m)	重量 Weight (kg)
		(m³/h)	(L/s)					
80DL50-20	2	32.4	9	42	11	1480	2.2	570
		50.4	14	40			2.5	
		65	18	36			2.8	
	3	32.4	9	63	15	1480	2.2	640
		50.4	14	60			2.5	
		65	18	54			2.8	
	4	32.4	9	84	22	1480	2.2	760
		50.4	14	80			2.5	
		65	18	72			2.8	
	5	32.4	9	105	30	1480	2.2	900
		50.4	14	100			2.5	
		65	18	90			2.8	
80DL50-20	7	32.4	9	151	37	1480	2.2	1040
		50.4	14	140			2.5	
		65	18	120			2.8	
	8	32.4	9	173	45	1480	2.2	1120
		50.4	14	160			2.5	
		65	18	137			2.8	
	9	32.4	9	194	45	1480	2.2	1175
		50.4	14	180			2.5	
		65	18	154			2.8	
	10	32.4	9	216	55	1480	2.2	1335
		50.4	14	200			2.5	
		65	18	171			2.8	

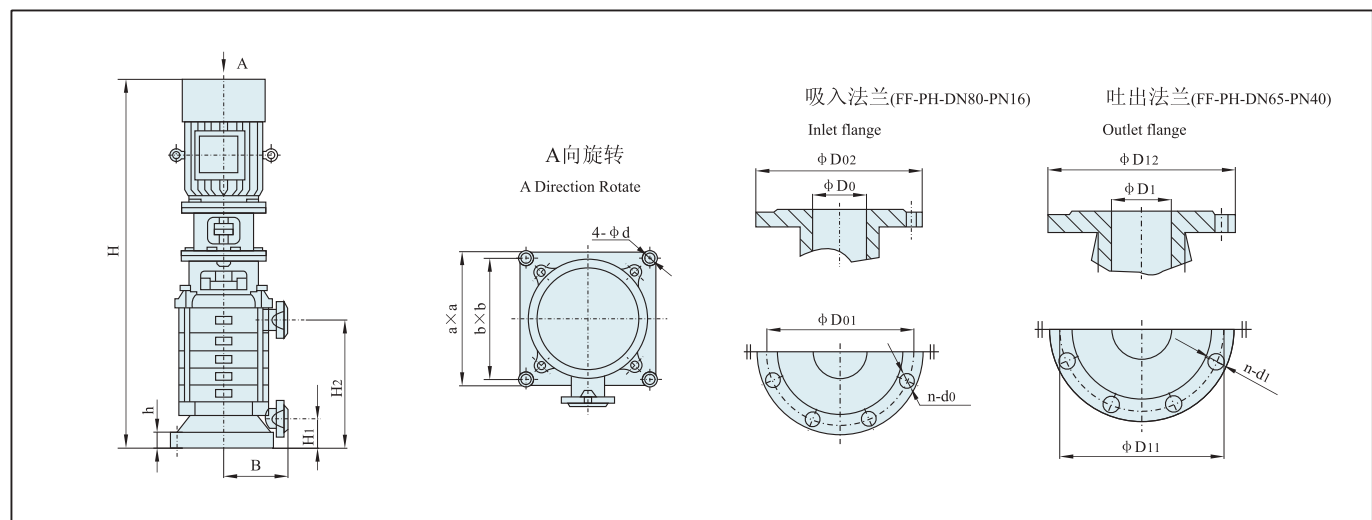

泵型号 Pump model	级数 Series	外形尺寸 Figure dimension		安装尺寸 Installation dimension						吸入法兰 Inlet flange				吐出法兰 Outlet flange			
		H	a×a	H <sub>1</sub>	H <sub>2</sub>	h	B	b×b	4-φd	D <sub>0</sub>	D <sub>01</sub>	D <sub>02</sub>	n-φd <sub>0</sub>	D <sub>1</sub>	D <sub>11</sub>	D <sub>12</sub>	n-φd <sub>1</sub>
80DL50-20	2	1396	470×470	150	427	55	280	410×410	φ26	80	160	200	8-φ17.5	65	145	185	4-φ17.5
	3	1530	470×470	150	516	55	280	410×410	φ26	80	160	200	8-φ17.5	65	145	185	4-φ17.5
	4	1684	470×470	150	605	55	280	410×410	φ26	80	160	200	8-φ17.5	65	145	185	4-φ17.5
	5	1838	470×470	150	694	55	280	410×410	φ26	80	160	200	8-φ17.5	65	145	185	4-φ17.5
	6	1927	470×470	150	783	55	280	410×410	φ26	80	160	200	8-φ17.5	65	145	185	4-φ17.5
	7	2061	470×470	150	872	55	280	410×410	φ26	80	160	200	8-φ17.5	65	145	185	4-φ17.5
	8	2175	470×470	150	961	55	280	410×410	φ26	80	160	200	8-φ17.5	65	145	185	4-φ17.5
	9	2264	470×470	150	1050	55	280	410×410	φ26	80	160	200	8-φ17.5	65	145	185	4-φ17.5
	10	2543	470×470	150	1139	55	280	410×410	φ26	80	160	200	8-φ17.5	65	145	185	4-φ17.5



## DL型泵性能曲线图 DL type pump performance curve chart

100DL72-20×2~100DL72-20×10

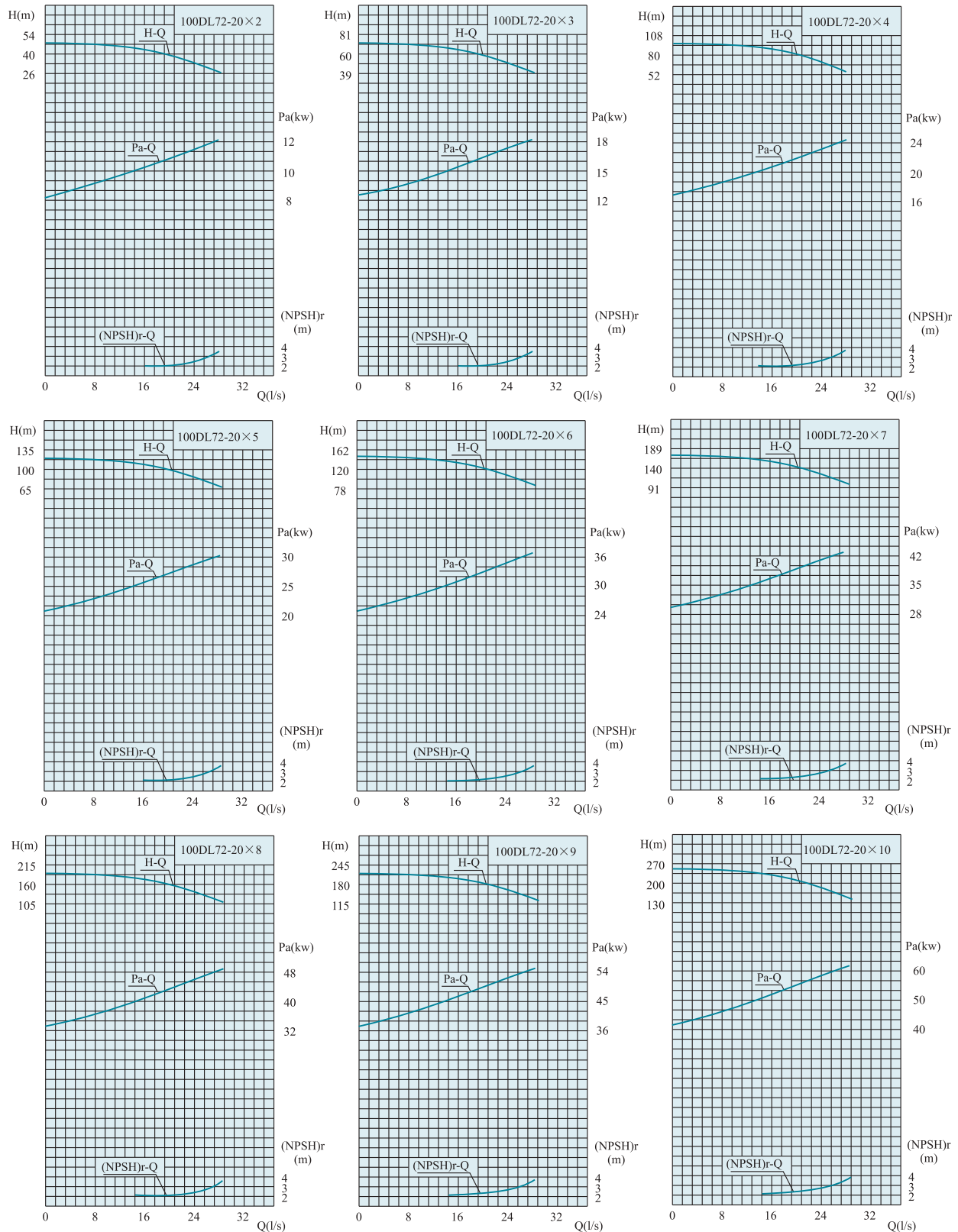

## DL型泵性能参数及外形安装尺寸图表 Performance data and installation drawing table

泵型号 Pump model	级数 Series	流量Capacity		扬程 Head (m)	功率 Power (kW)	转速 Speed (r/min)	必需汽蚀量 (NPSH) <sub>r</sub> (m)	重量 Weight (kg)
		(m³/h)	(L/s)					
100DL72-20	2	50.4	14	46	15	1480	2.2	755
		72	20	40			2.8	
		86.4	24	36			3.1	
	3	50.4	14	69	22	1480	2.2	890
		72	20	60			2.8	
		86.4	24	54			3.1	
	4	50.4	14	92	30	1480	2.2	985
		72	20	80			2.8	
		86.4	24	72			3.1	
	5	50.4	14	115	37	1480	2.2	1070
		72	20	100			2.8	
		86.4	24	90			3.1	
100DL72-20	7	50.4	14	157	45	1480	2.2	1435
		72	20	140			2.8	
		86.4	24	126			3.1	
	8	50.4	14	184	55	1480	2.2	1490
		72	20	160			2.8	
		86.4	24	144			3.1	
	9	50.4	14	207	55	1480	2.2	1590
		72	20	180			2.8	
		86.4	24	162			3.1	
	10	50.4	14	230	75	1480	2.2	1650
		72	20	200			2.8	
		86.4	24	180			3.1	

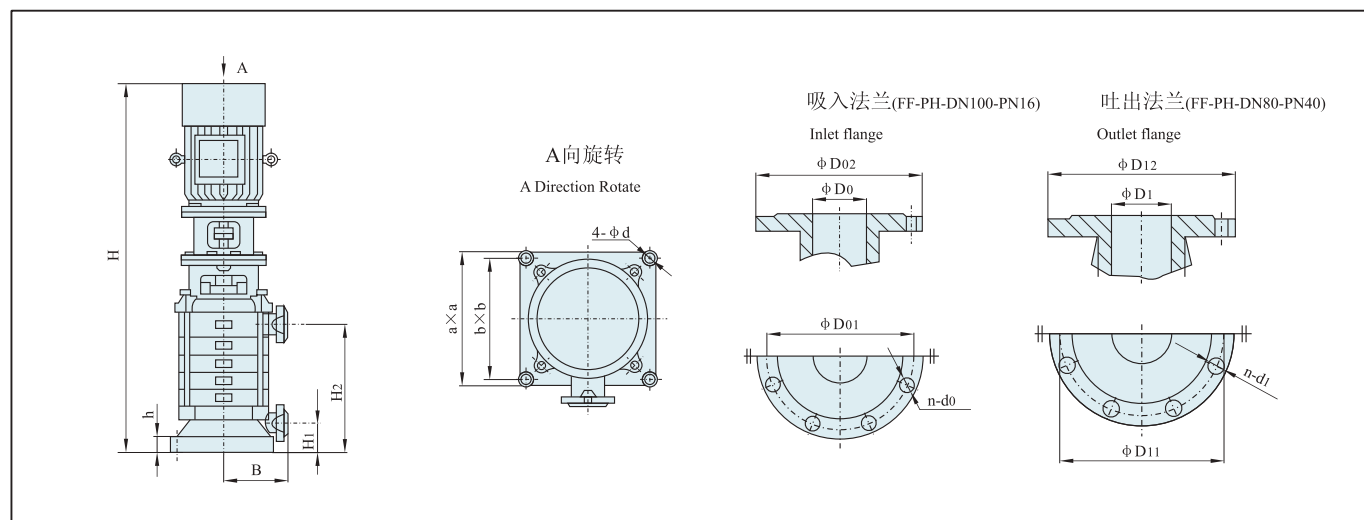

泵型号 Pump model	级数 Series	外形尺寸 Figure dimension		安装尺寸 Installation dimension						吸入法兰 Inlet flange				吐出法兰 Outlet flange			
		H	a×a	H <sub>1</sub>	H <sub>2</sub>	h	B	b×b	4-φd	D <sub>0</sub>	D <sub>01</sub>	D <sub>02</sub>	n-φd <sub>0</sub>	D <sub>1</sub>	D <sub>11</sub>	D <sub>12</sub>	n-φd <sub>1</sub>
100DL72-20	2	1460	465×465	172	467	50	280	410×410	φ 24	100	180	220	8-φ 17.5	80	160	200	8-φ 17.5
	3	1628	465×465	172	570	50	280	410×410	φ 24	100	180	220	8-φ 17.5	80	160	200	8-φ 17.5
	4	1796	465×465	172	673	50	280	410×410	φ 24	100	180	220	8-φ 17.5	80	160	200	8-φ 17.5
	5	1944	465×465	172	776	50	280	410×410	φ 24	100	180	220	8-φ 17.5	80	160	200	8-φ 17.5
	6	2072	465×465	172	879	50	280	410×410	φ 24	100	180	220	8-φ 17.5	80	160	200	8-φ 17.5
	7	2365	465×465	172	982	50	280	410×410	φ 24	100	180	220	8-φ 17.5	80	160	200	8-φ 17.5
	8	2468	465×465	172	1085	50	280	410×410	φ 24	100	180	220	8-φ 17.5	80	160	200	8-φ 17.5
	9	2656	465×465	172	1188	50	280	410×410	φ 24	100	180	220	8-φ 17.5	80	160	200	8-φ 17.5
	10	2759	465×465	172	1291	50	280	410×410	φ 24	100	180	220	8-φ 17.5	80	160	200	8-φ 17.5

## DL型泵性能曲线图 DL type pump performance curve chart

100DL100-20×2~100DL100-20×10

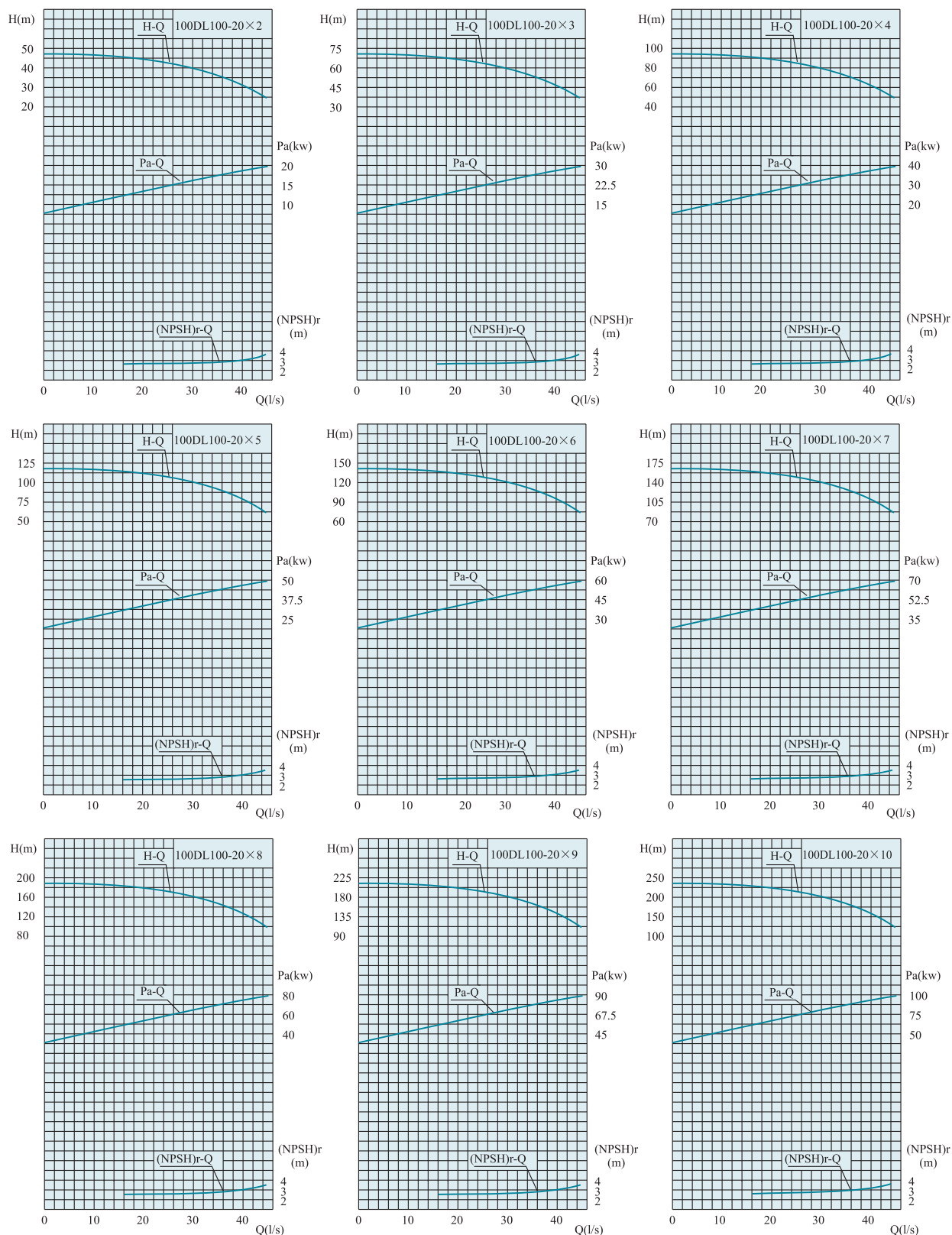

## DL型泵性能参数及外形安装尺寸图表 Performance data and installation drawing table

泵型号 Pump model	级数 Series	流量Capacity		扬程 Head (m)	功率 Power (kW)	转速 Speed (r/min)	必需汽蚀量 (NPSH) <sub>r</sub> (m)	重量 Weight (kg)
		(m³/h)	(L/s)					
100DL100-20	2	72	20	46	18.5	1480	2.8	765
		100	27.8	40			3.5	
		126	35	36			4.4	
	3	72	20	69	30	1480	2.8	900
		100	27.8	60			3.5	
		126	35	54			4.4	
	4	72	20	92	37	1480	2.8	995
		100	27.8	80			3.5	
		126	35	72			4.4	
	5	72	20	115	45	1480	2.8	1080
		100	27.8	100			3.5	
		126	35	90			4.4	
100DL100-20	7	72	20	157	75	1480	2.8	1445
		100	27.8	140			3.5	
		126	35	126			4.4	
	8	72	20	184	75	1480	2.8	1500
		100	27.8	160			3.5	
		126	35	144			4.4	
	9	72	20	207	90	1480	2.8	1600
		100	27.8	180			3.5	
		126	35	162			4.4	
	10	72	20	230	90	1480	2.8	1660
		100	27.8	200			3.5	
		126	35	180			4.4	

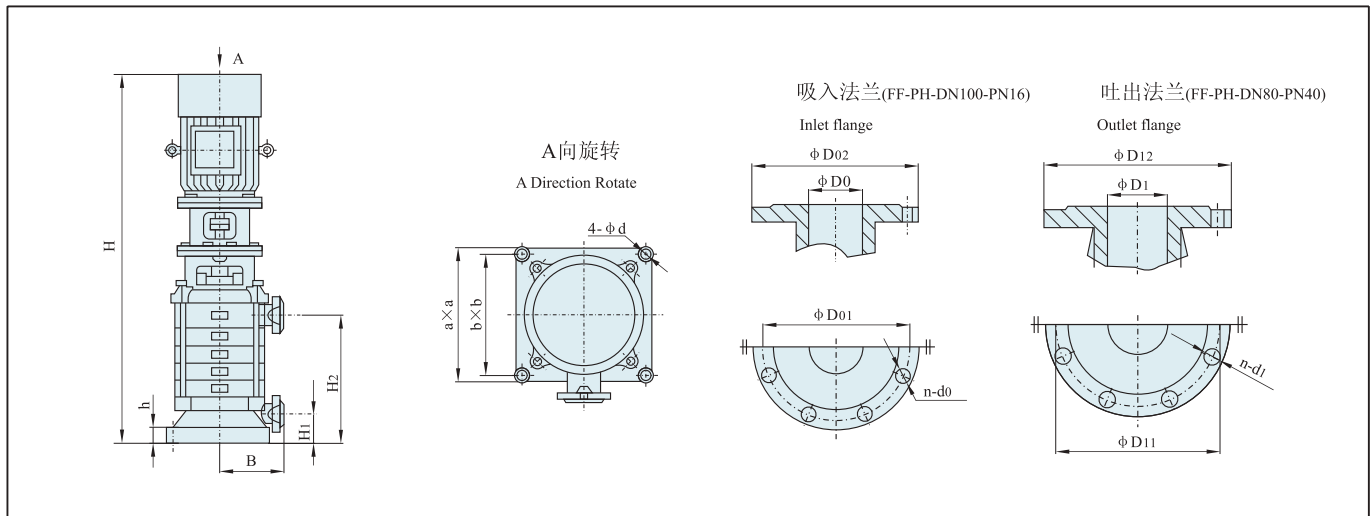

泵型号 Pump model	级数 Series	外形尺寸 Figure dimension		安装尺寸 Installation dimension						吸入法兰 Inlet flange				吐出法兰 Outlet flange			
		H	a×a	H <sub>1</sub>	H <sub>2</sub>	h	B	b×b	4-φd	D <sub>0</sub>	D <sub>01</sub>	D <sub>02</sub>	n-φd <sub>0</sub>	D <sub>1</sub>	D <sub>11</sub>	D <sub>12</sub>	n-φd <sub>1</sub>
100DL100-20	2	1485	465×465	172	467	50	280	410×410	φ 24	100	180	220	8-φ 17.5	80	160	200	8-φ 17.5
	3	1693	465×465	172	570	50	280	410×410	φ 24	100	180	220	8-φ 17.5	80	160	200	8-φ 17.5
	4	1841	465×465	172	673	50	280	410×410	φ 24	100	180	220	8-φ 17.5	80	160	200	8-φ 17.5
	5	1969	465×465	172	776	50	280	410×410	φ 24	100	180	220	8-φ 17.5	80	160	200	8-φ 17.5
	6	2262	465×465	172	879	50	280	410×410	φ 24	100	180	220	8-φ 17.5	80	160	200	8-φ 17.5
	7	2450	465×465	172	982	50	280	410×410	φ 24	100	180	220	8-φ 17.5	80	160	200	8-φ 17.5
	8	2553	465×465	172	1085	50	280	410×410	φ 24	100	180	220	8-φ 17.5	80	160	200	8-φ 17.5
	9	2706	465×465	172	1188	50	280	410×410	φ 24	100	180	220	8-φ 17.5	80	160	200	8-φ 17.5
	10	2809	465×465	172	1291	50	280	410×410	φ 24	100	180	220	8-φ 17.5	80	160	200	8-φ 17.5

## DL型泵性能曲线图 DL type pump performance curve chart

150DL150-20×2~150DL150-20×10

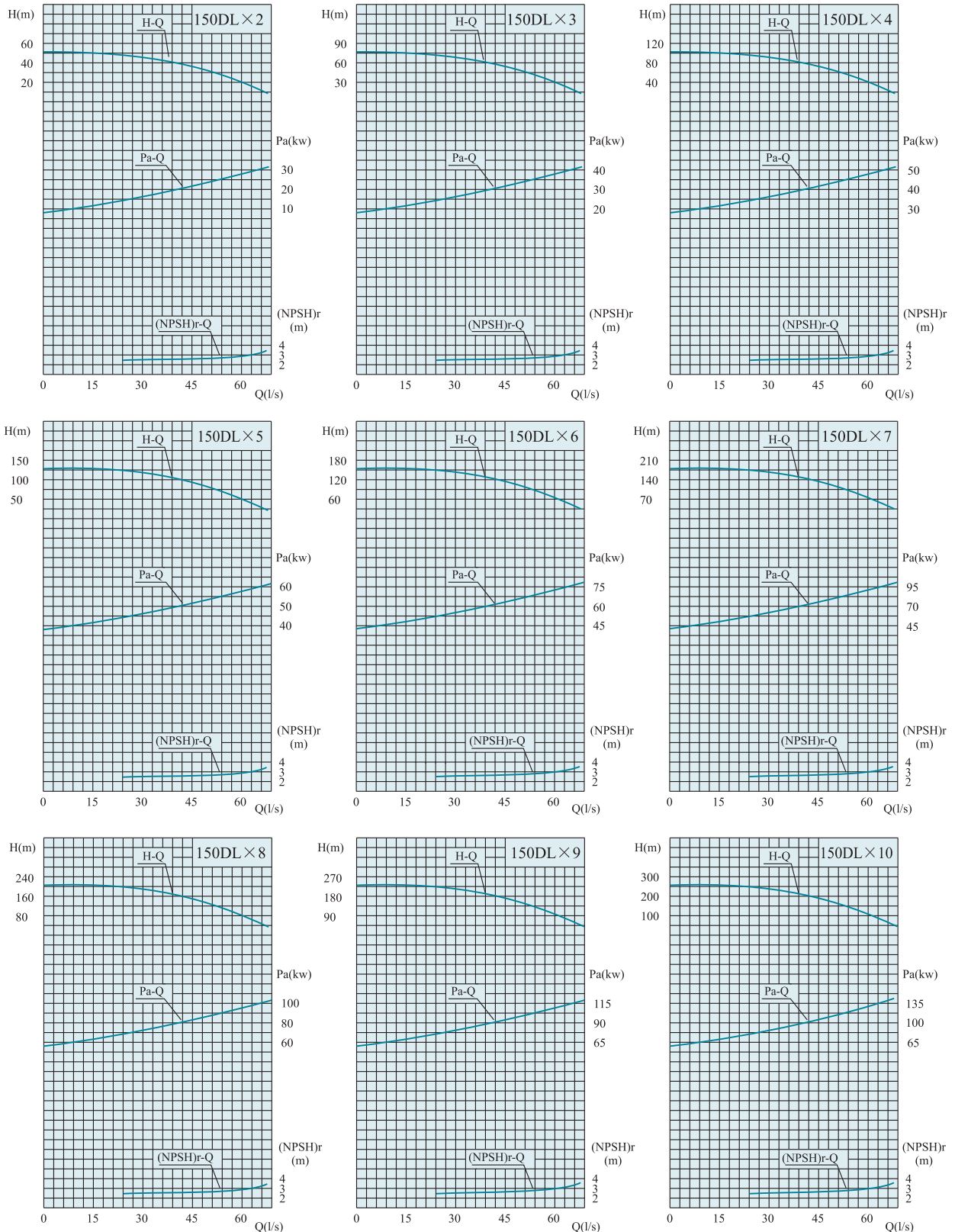

## DL型泵性能参数及外形安装尺寸图表 Performance data and installation drawing table

泵型号 Pump model	级数 Series	流量Capacity		扬程 Head (m)	功率 Power (kW)	转速 Speed (r/min)	必需汽蚀量 (NPSH) <sub>r</sub> (m)	重量 Weight (kg)
		(m³/h)	(L/s)					
150DL150-20	2	108	30	45	30	1480	2.2	815
		150	41.6	40			2.8	
		180	50	34			3.7	
	3	108	30	67.5	37	1480	2.2	960
		150	41.6	60			2.8	
		180	50	51			3.7	
	4	108	30	90	45	1480	2.2	1100
		150	41.6	80			2.8	
		180	50	68			3.7	
	5	108	30	112.5	55	1480	2.2	1245
		150	41.6	100			2.8	
		180	50	85			3.7	
	6	108	30	135	75	1480	2.2	1410
		150	41.6	120			2.8	
		180	50	102			3.7	

泵型号 Pump model	级数 Series	流量Capacity		扬程 Head (m)	功率 Power (kW)	转速 Speed (r/min)	必需汽蚀量 (NPSH) <sub>r</sub> (m)	重量 Weight (kg)
		(m³/h)	(L/s)					
150DL150-20	7	108	30	157.5	90	1480	2.2	1560
		150	41.6	140			2.8	
		180	50	119			3.7	
	8	108	30	180	90	1480	2.2	1710
		150	41.6	160			2.8	
		180	50	136			3.7	
	9	108	30	200	110	1480	2.2	1870
		150	41.6	180			2.8	
		180	50	156			3.7	
	10	108	30	220	132	1480	2.2	2050
		150	41.6	200			2.8	
		180	50	176			3.7	

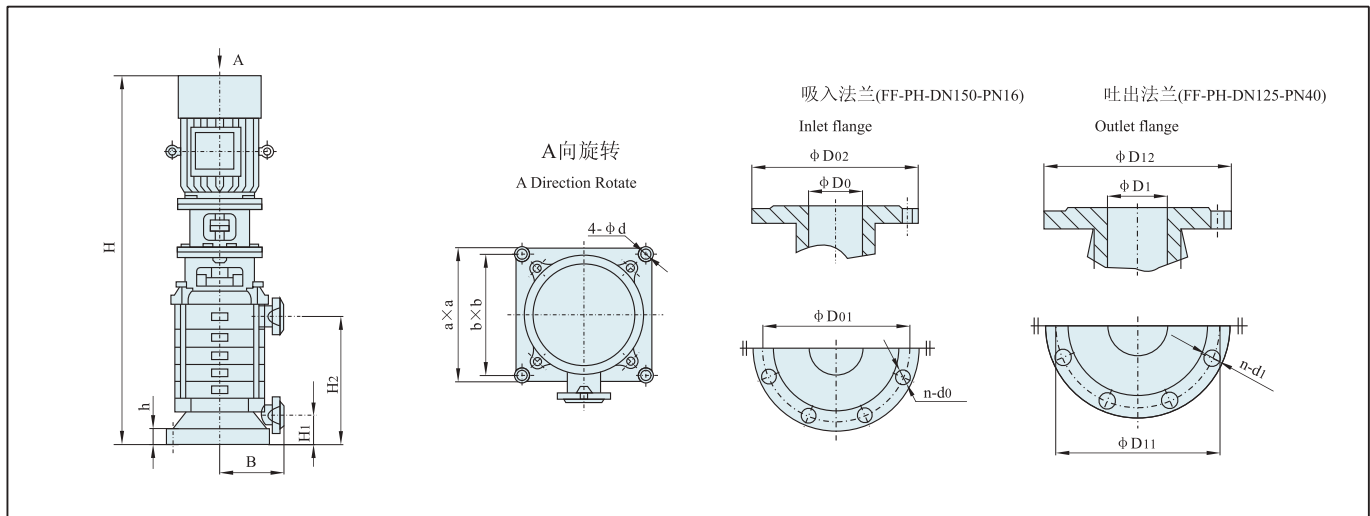

泵型号 Pump model	级数 Series	外形尺寸 Figure dimension		安装尺寸 Installation dimension						吸入法兰 Inlet flange				吐出法兰 Outlet flange			
		H	a×a	H <sub>1</sub>	H <sub>2</sub>	h	B	b×b	4-φd	D <sub>0</sub>	D <sub>01</sub>	D <sub>02</sub>	n-φ <sub>22</sub>	D <sub>1</sub>	D <sub>11</sub>	D <sub>12</sub>	n-φ <sub>26</sub>
150DL150-20	2	1745	480×480	208	559	65	380	430×430	φ 26	150	240	285	8-φ 22	125	220	270	8-φ 26
	3	1920	480×480	208	689	65	380	430×430	φ 26	150	240	285	8-φ 22	125	220	270	8-φ 26
	4	2265	480×480	208	819	65	380	430×430	φ 26	150	240	285	8-φ 22	125	220	270	8-φ 26
	5	2480	480×480	208	949	65	380	430×430	φ 26	150	240	285	8-φ 22	125	220	270	8-φ 26
	6	2610	480×480	208	1079	65	380	430×430	φ 26	150	240	285	8-φ 22	125	220	270	8-φ 26
	7	2790	480×480	208	1209	65	380	430×430	φ 26	150	240	285	8-φ 22	125	220	270	8-φ 26
	8	3140	480×480	208	1339	65	380	430×430	φ 26	150	240	285	8-φ 22	125	220	270	8-φ 26
	9	3270	480×480	208	1469	65	380	430×430	φ 26	150	240	285	8-φ 22	125	220	270	8-φ 26
	10	3500	480×480	208	1599	65	380	430×430	φ 26	150	240	285	8-φ 22	125	220	270	8-φ 26



## DL型泵性能曲线图 DL type pump performance curve chart

150DL160-25×2~150DL160-25×9

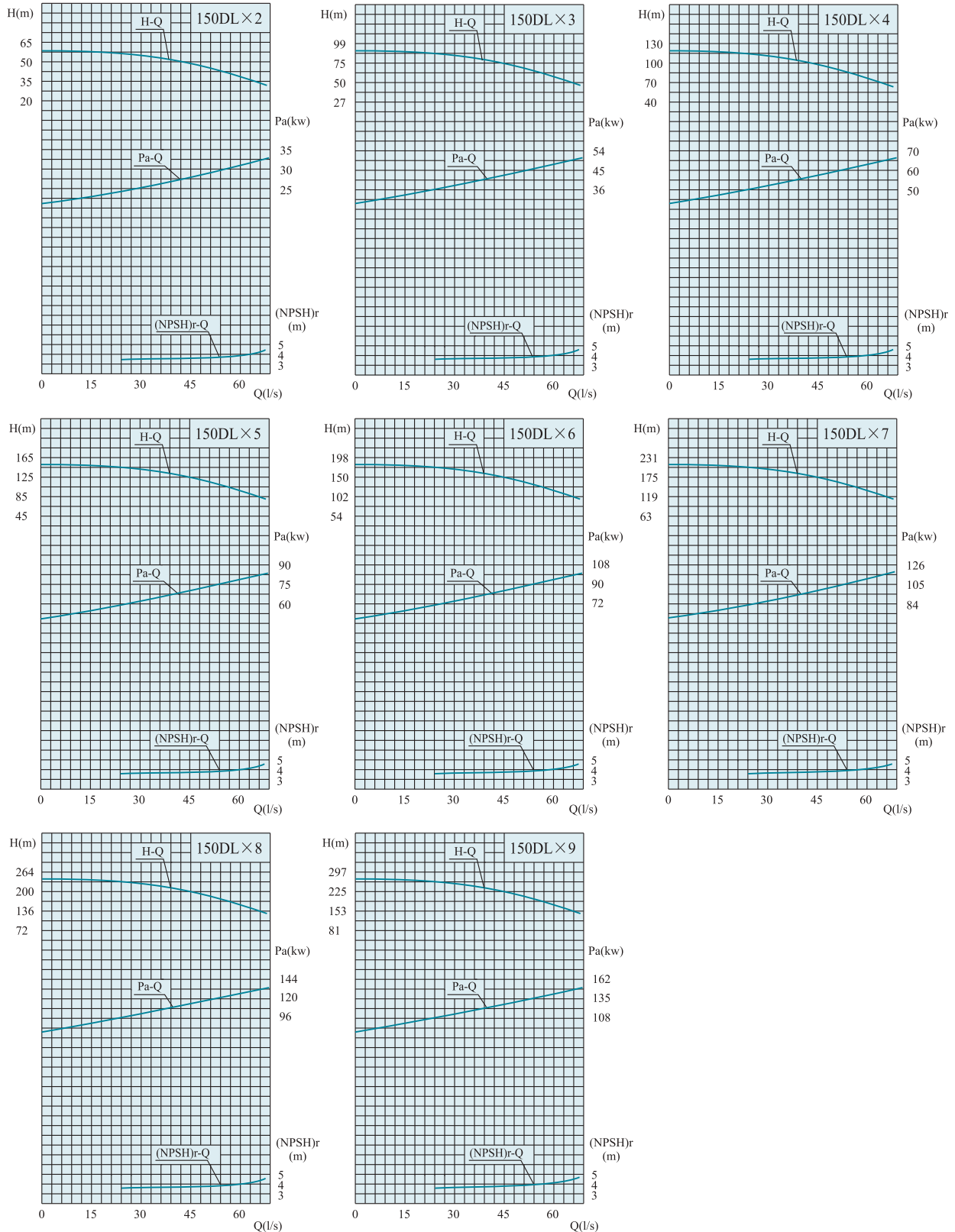

## DL型泵性能参数及外形安装尺寸图表 Performance data and installation drawing table

泵型号 Pump model	级数 Series	流量Capacity		扬程 Head (m)	功率 Power (kW)	转速 Speed (r/min)	必需汽蚀量 (NPSH) <sub>r</sub> (m)	重量 Weight (kg)
		(m³/h)	(L/s)					
150DL160-25	2	120	33.3	53	37	1480	3.1	825
		160	44.4	50			3.5	
		200	55.6	44			3.8	
	3	120	33.3	79.5	55	1480	3.1	970
		160	44.4	75			3.5	
		200	55.6	66			3.8	
	4	120	33.3	106	75	1480	3.1	1110
		160	44.4	100			3.5	
		200	55.6	88			3.8	
	5	120	33.3	133	90	1480	3.1	1255
		160	44.4	125			3.5	
		200	55.6	110			3.8	

泵型号 Pump model	级数 Series	流量Capacity		扬程 Head (m)	功率 Power (kW)	转速 Speed (r/min)	必需汽蚀量 (NPSH) <sub>r</sub> (m)	重量 Weight (kg)
		(m³/h)	(L/s)					
150DL160-25	6	120	33.3	159	110	1480	3.1	1410
		160	44.4	150			3.5	
		200	55.6	132			3.8	
	7	120	33.3	186	132	1480	3.1	1570
		160	44.4	175			3.5	
		200	55.6	154			3.8	
	8	120	33.3	212	132	1480	3.1	1720
		160	44.4	200			3.5	
		200	55.6	176			3.8	
	9	120	33.3	239	160	1480	3.1	1880
		160	44.4	225			3.5	
		200	55.6	198			3.8	

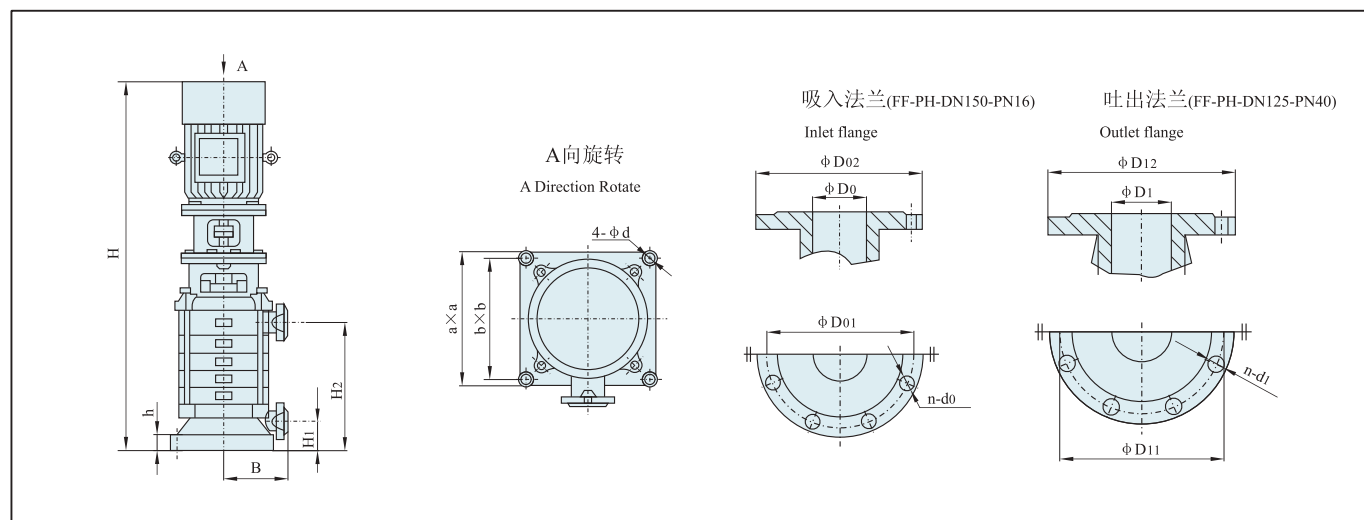

泵型号 Pump model	级数 Series	外形尺寸 Figure dimension		安 装 尺 寸 Installation dimension						吸 入 法 兰 Inlet flange				吐 出 法 兰 Outlet flange			
		H	a×a	H <sub>1</sub>	H <sub>2</sub>	h	B	b×b	4-φd	D <sub>0</sub>	D <sub>01</sub>	D <sub>02</sub>	n-d <sub>0</sub>	D <sub>1</sub>	D <sub>11</sub>	D <sub>12</sub>	n-d <sub>1</sub>
150DL160-25	2	1985	600×600	213	559	73	380	550×550	φ 24	150	240	285	8-φ 22	125	220	270	8-φ 26
	3	2330	600×600	213	689	73	380	550×550	φ 24	150	240	285	8-φ 22	125	220	270	8-φ 26
	4	2545	600×600	213	819	73	380	550×550	φ 24	150	240	285	8-φ 22	125	220	270	8-φ 26
	5	2725	600×600	213	949	73	380	550×550	φ 24	150	240	285	8-φ 22	125	220	270	8-φ 26
	6	3075	600×600	213	1079	73	380	550×550	φ 24	150	240	285	8-φ 22	125	220	270	8-φ 26
	7	3305	600×600	213	1209	73	380	550×550	φ 24	150	240	285	8-φ 22	125	220	270	8-φ 26
	8	3435	600×600	213	1339	73	380	550×550	φ 24	150	240	285	8-φ 22	125	220	270	8-φ 26
	9	3565	600×600	213	1469	73	380	550×550	φ 24	150	240	285	8-φ 22	125	220	270	8-φ 26

## DL型泵性能曲线图 DL type pump performance curve chart

150DL200-20×2~150DL200-20×10

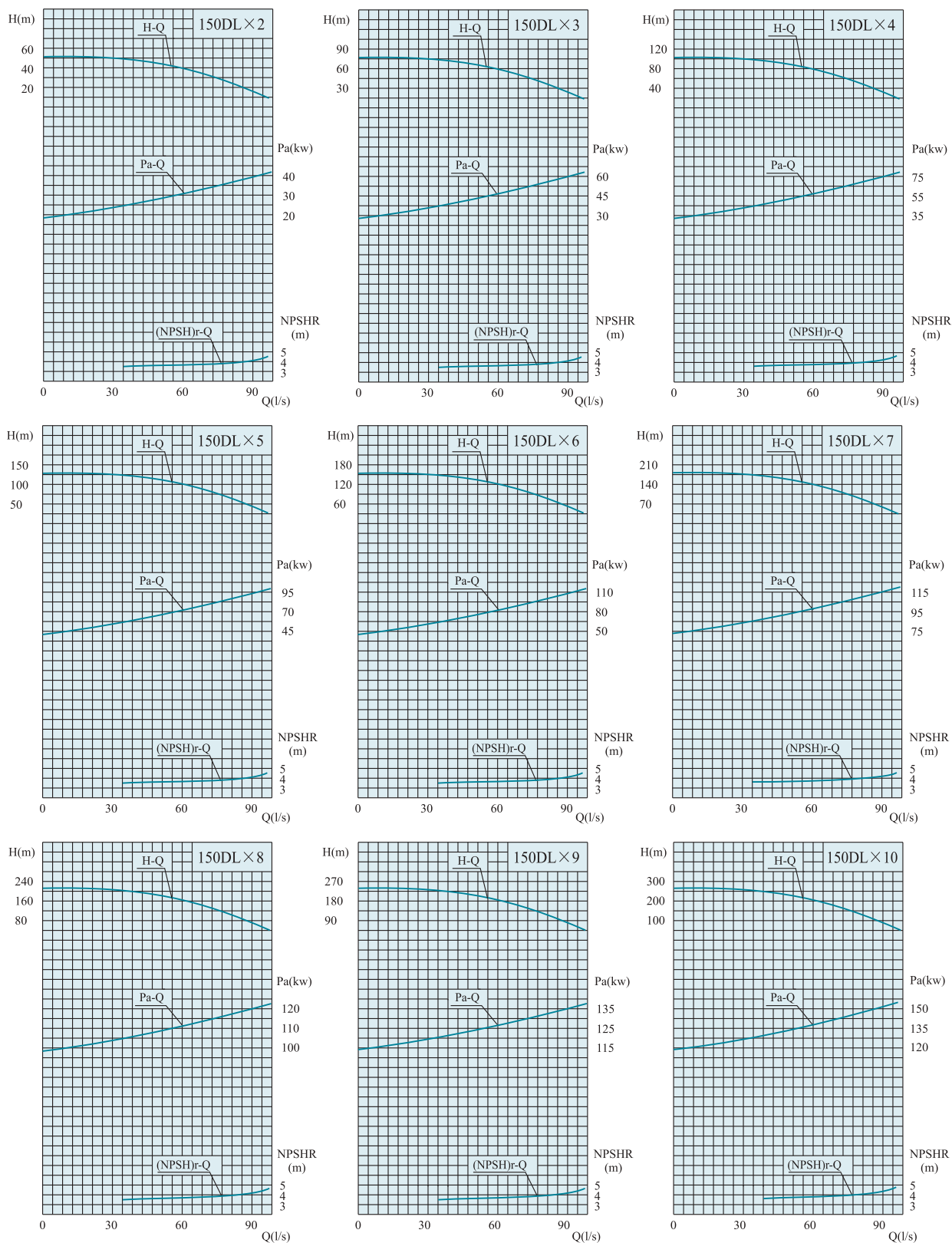

## DL型泵性能参数及外形安装尺寸图表 Performance data and installation drawing table

泵型号 Pump model	级数 Series	流量Capacity		扬程 Head (m)	功率 Power (kW)	转速 Speed (r/min)	必需汽蚀量 (NPSH) <sub>r</sub> (m)	重量 Weight (kg)
		(m³/h)	(L/s)					
150DL200-20	2	140	38.9	45	37	1480	3	825
		200	55.6	40			3.5	
		240	66.7	34			4.1	
	3	140	38.9	67.5	55	1480	3	970
		200	55.6	60			3.5	
		240	66.7	51			4.1	
	4	140	38.9	90	75	1480	3	1110
		200	55.6	80			3.5	
		240	66.7	68			4.1	
	5	140	38.9	112.5	90	1480	3	1255
		200	55.6	100			3.5	
		240	66.7	85			4.1	
	6	140	38.9	135	110	1480	3	1410
		200	55.6	120			3.5	
		240	66.7	102			4.1	

泵型号 Pump model	级数 Series	流量Capacity		扬程 Head (m)	功率 Power (kW)	转速 Speed (r/min)	必需汽蚀量 (NPSH) <sub>r</sub> (m)	重量 Weight (kg)
		(m³/h)	(L/s)					
150DL200-20	7	140	38.9	157.5	132	1480	3	1570
		200	55.6	140			3.5	
		240	66.7	119			4.1	
	8	140	38.9	180	132	1480	3	1720
		200	55.6	160			3.5	
		240	66.7	136			4.1	
	9	140	38.9	200	160	1480	3	1880
		200	55.6	180			3.5	
		240	66.7	156			4.1	
	10	140	38.9	220	160	1480	3	2050
		200	55.6	200			3.5	
		240	66.7	176			4.1	

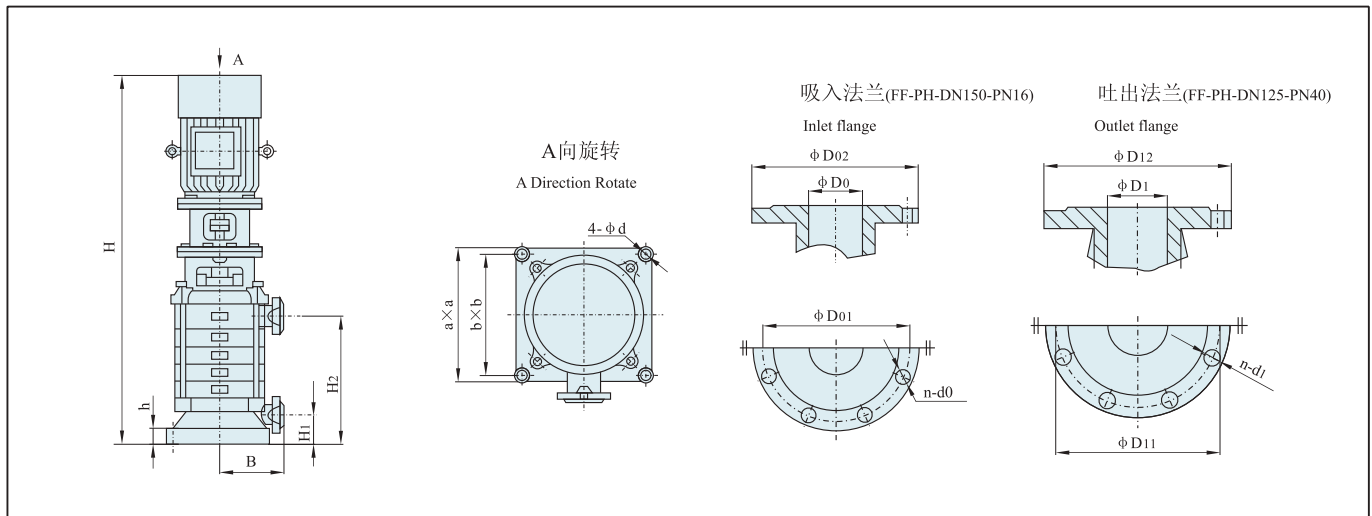

泵型号 Pump model	级数 Series	外形尺寸 Figure dimension		安装尺寸 Installation dimension						吸入法兰 Inlet flange				吐出法兰 Outlet flange			
		H	a×a	H <sub>1</sub>	H <sub>2</sub>	h	B	b×b	4-φd	D <sub>0</sub>	D <sub>01</sub>	D <sub>02</sub>	n-φ <sub>22</sub>	D <sub>1</sub>	D <sub>11</sub>	D <sub>12</sub>	n-φ <sub>26</sub>
150DL200-20	2	1985	600×600	213	559	73	380	550×550	φ 24	150	240	285	8-φ 22	125	220	270	8-φ 26
	3	2330	600×600	213	689	73	380	550×550	φ 24	150	240	285	8-φ 22	125	220	270	8-φ 26
	4	2545	600×600	213	819	73	380	550×550	φ 24	150	240	285	8-φ 22	125	220	270	8-φ 26
	5	2725	600×600	213	949	73	380	550×550	φ 24	150	240	285	8-φ 22	125	220	270	8-φ 26
	6	3075	600×600	213	1079	73	380	550×550	φ 24	150	240	285	8-φ 22	125	220	270	8-φ 26
	7	3205	600×600	213	1209	73	380	550×550	φ 24	150	240	285	8-φ 22	125	220	270	8-φ 26
	8	3435	600×600	213	1339	73	380	550×550	φ 24	150	240	285	8-φ 22	125	220	270	8-φ 26
	9	3565	600×600	213	1469	73	380	550×550	φ 24	150	240	285	8-φ 22	125	220	270	8-φ 26
	10	3695	600×600	213	1599	73	380	550×550	φ 24	150	240	285	8-φ 22	125	220	270	8-φ 26

## DL型泵性能曲线图 DL type pump performance curve chart

200DL300-20×2~200DL300-20×8

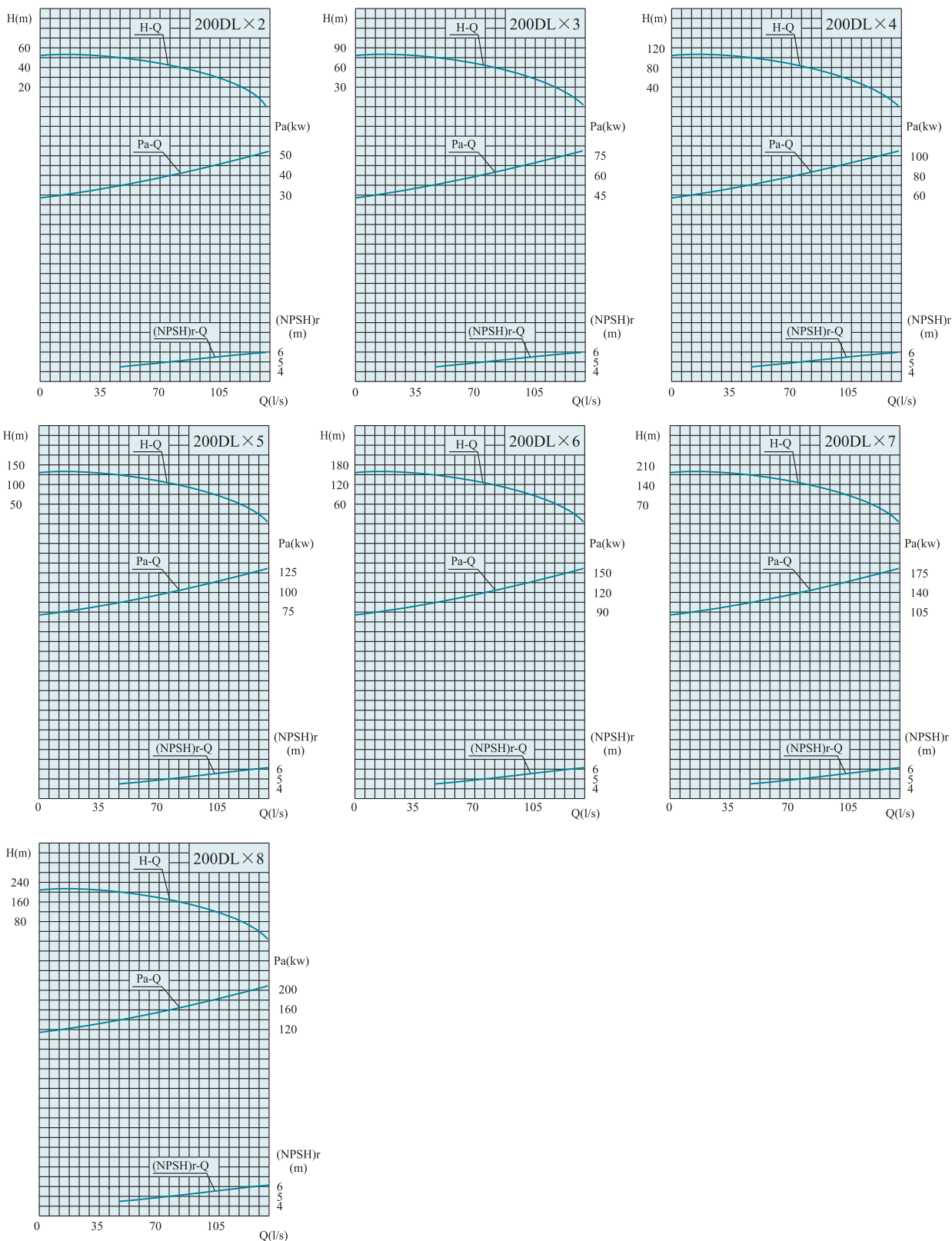

## DL型泵性能参数及外形安装尺寸图表 Performance data and installation drawing table

泵型号 Pump model	级数 Series	流量Capacity		扬程 Head (m)	功率 Power (kW)	转速 Speed (r/min)	必需汽蚀量 (NPSH) <sub>r</sub> (m)	重量 Weight (kg)
		(m³/h)	(L/s)					
200DL300-20	2	210	58.3	45	55	1480	4.2	1080
		300	83.3	40			5	
		360	100	36			5.5	
	3	210	58.3	65.5	75	1480	4.2	1340
		300	83.3	60			5	
		360	100	54.5			5.5	
	4	210	58.3	86	110	1480	4.2	1900
		300	83.3	80			5	
		360	100	74			5.5	
	5	210	58.3	106	132	1480	4.2	2150
		300	83.3	100			5	
		360	100	95			5.5	
200DL300-20	6	210	58.3	127	160	1480	4.2	2400
		300	83.3	120			5	
		360	100	114			5.5	
	7	210	58.3	146	160	1480	4.2	2550
		300	83.3	140			5	
		360	100	134			5.5	
	8	210	58.3	166.5	200	1480	4.2	2700
		300	83.3	160			5	
		360	100	150			5.5	

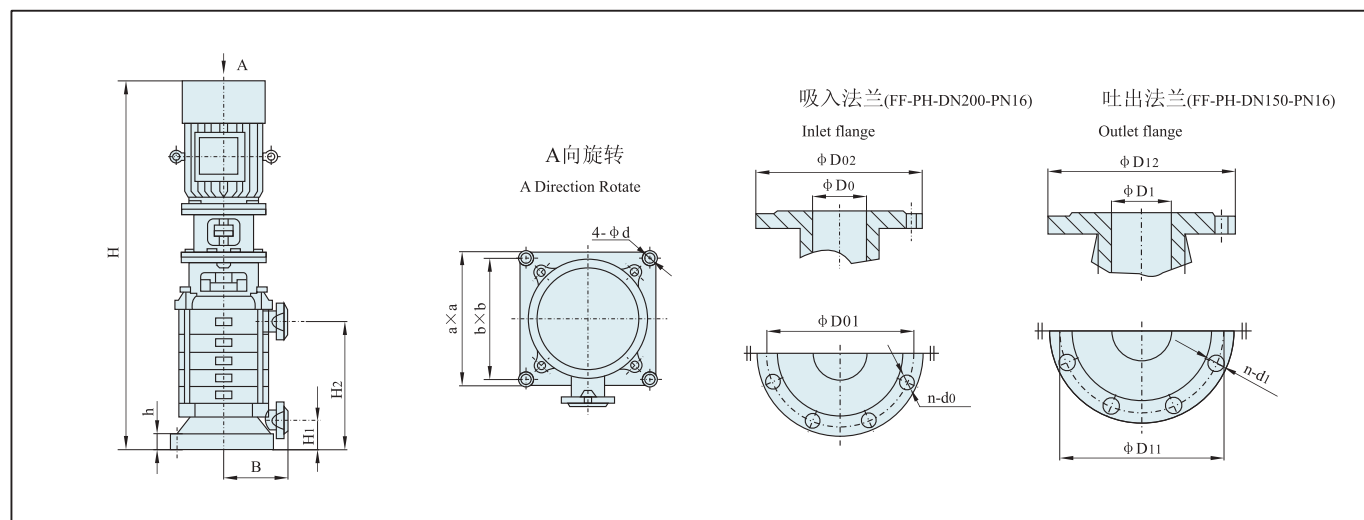

泵型号 Pump model	级数 Series	外形尺寸 Figure dimension		安装尺寸 Installation dimension						吸入法兰 Inlet flange				吐出法兰 Outlet flange			
		H	a × a	H <sub>1</sub>	H <sub>2</sub>	h	B	b × b	4-φd	D <sub>0</sub>	D <sub>01</sub>	D <sub>02</sub>	n-φ23	D <sub>1</sub>	D <sub>11</sub>	D <sub>12</sub>	n-d1
200DL300-20	2	2115	550 × 550	182	624	50	350	480 × 480	φ 27	200	295	340	12-φ 23	150	240	285	8-φ 23
	3	2385	550 × 550	182	808	50	350	480 × 480	φ 27	200	295	340	12-φ 23	150	240	285	8-φ 23
	4	2840	550 × 550	182	992	50	350	480 × 480	φ 27	200	295	340	12-φ 23	150	240	285	8-φ 23
	5	3125	550 × 550	182	1176	50	350	480 × 480	φ 27	200	295	340	12-φ 23	150	240	285	8-φ 23
	6	3305	550 × 550	182	1360	50	350	480 × 480	φ 27	200	295	340	12-φ 23	150	240	285	8-φ 23
	7	3490	550 × 550	182	1544	50	350	480 × 480	φ 27	200	295	340	12-φ 23	150	240	285	8-φ 23
	8	3675	550 × 550	182	1728	50	350	480 × 480	φ 27	200	295	340	12-φ 23	150	240	285	8-φ 23



## 泵的几种安装方法 Several ways of installation

硬性联接（直接安装） Hard Link(Directly Mounted)

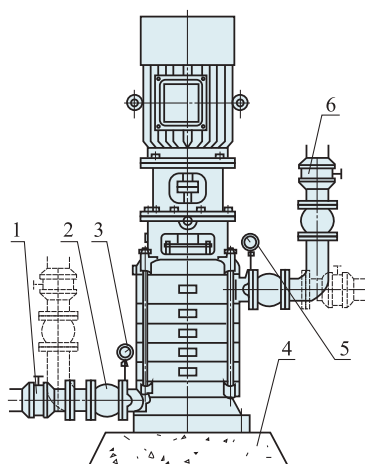

1	进口阀门 inlet valve
2	挠性接头 flexible union
3	进口压力表 inlet manometer
4	基础 basis
5	出口压力表 outlet manometer
6	出口阀门 outlet valve

柔性联接（联接板+隔振垫） Soft Link(Link Plate+Vibration Isolation Pad)

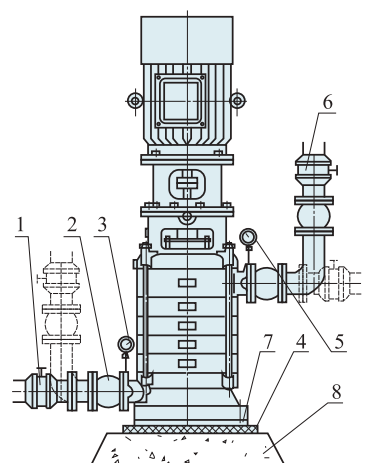

1	进口阀门 inlet valve
2	挠性接头 flexible union
3	进口压力表 inlet manometer
4	隔振垫 vibration isolation pad
5	出口压力表 outlet manometer
6	出口阀门 outlet valve
7	联接板 link plate
8	基础 basis

柔性联接（联接板+隔振垫） Soft Link(Link Plate+Vibration Isolator)

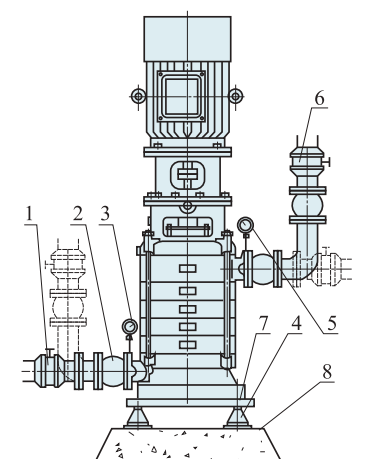

1	进口阀门 inlet valve
2	挠性接头 flexible union
3	进口压力表 inlet manometer
4	隔振器 vibration isolator
5	出口压力表 outlet manometer
6	出口阀门 outlet valve
7	联接板 link plate
8	基础 basis

## 泵附件图及其尺寸表 Fittings drawing and dimension table

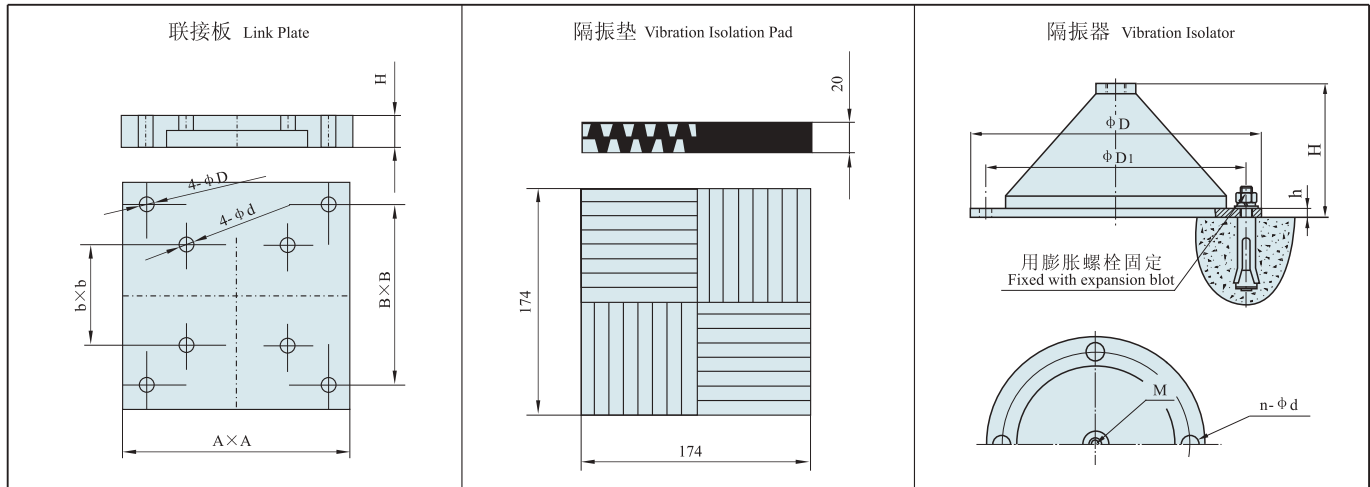

泵型号 Model	联接板尺寸 Link plate dimension							隔振器尺寸 Vibration isolator dimension							配膨胀螺栓规格 Expansion bolt specs
	型号 Model	A	B	b	M	$\phi D$	H	型号 Model	M	D	$D_1$	H	h	n- $\phi d$	
40DL	1#	650	600	300	M16	$\phi 15$	70	JG2-2	12	150	130	65	9	4- $\phi 8.5$	M8×80
50DL	2#	670	600	305	M16	$\phi 15$	70	JG2-2	12	150	130	65	9	4- $\phi 8.5$	M8×80
65DL	3#	720	650	370	M20	$\phi 20$	70	JG3-2	16	200	170	87	9	4- $\phi 12.5$	M12×110
80DL	4#	720	650	410	M20	$\phi 20$	70	JG3-2	16	200	170	87	9	4- $\phi 12.5$	M12×110
100DL	5#	720	650	410	M20	$\phi 25$	70	JG4-2	20	290	260	133	9	4- $\phi 12.5$	M12×110
150DL	6#	870	800	430/550	M24/M20	$\phi 25$	70	JG4-2	20	290	260	133	9	4- $\phi 12.5$	M12×110
200DL	7#	800	740	480	M24	$\phi 25$	70	JG4-2	20	290	260	133	9	4- $\phi 12.5$	M12×110

## 泵基础图及其联接尺寸 Basic drawing and link dimension

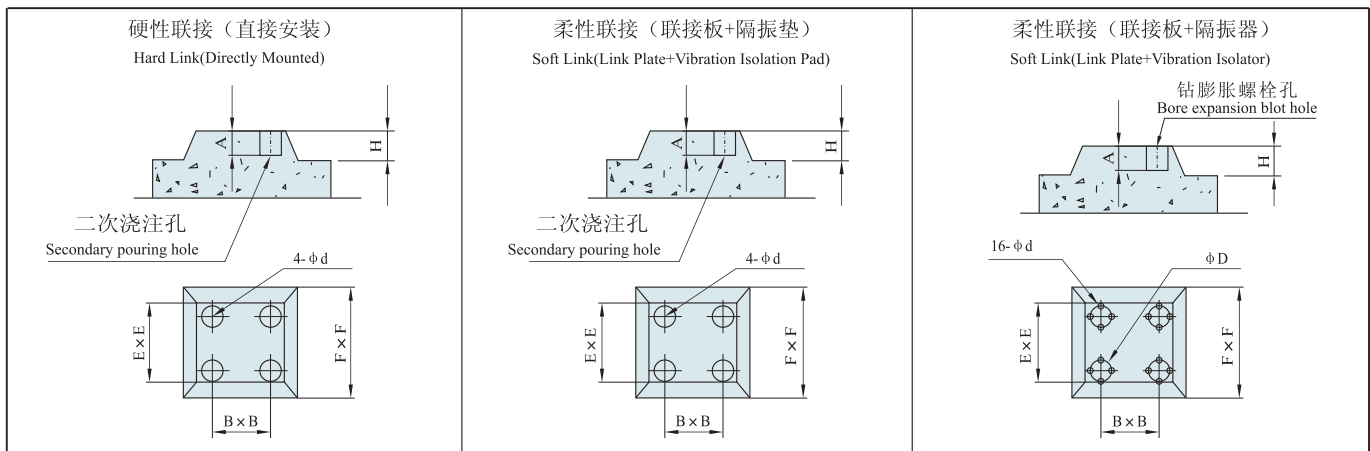

泵型号 Model	直接安装基础尺寸 Basic dimension for direct mounting							配联接板基础尺寸 Basic dimension with link plate							配联接板、隔振器基础尺寸 Basic dimension with link plate and vibration isolator						
	H	A	B	E	F	d	地脚螺栓规格 Foundation bolt specs	H	A	B	E	F	d	地脚螺栓规格 Foundation bolt specs	H	A	B	E	F	D	d
40DL	250	300	300	600	650	80	M16×300	250	200	600	950	1050	80	M12×200	250	50	600	950	1050	130	12.5
50DL	250	300	305	600	650	80	M16×300	250	200	600	950	1050	80	M12×200	250	50	600	950	1050	130	12.5
65DL	250	500	370	650	700	80	M24×500	250	400	650	1000	1100	80	M16×300	250	75	650	1000	1100	170	19
80DL	250	500	410	700	750	100	M20×400	250	400	650	1000	1100	100	M16×300	250	75	650	1000	1100	170	19
100DL	250	400	410	700	750	100	M20×400	250	300	650	1000	1100	100	M20×400	250	75	650	1000	1100	260	19
150DL	250	500	550	750	800	100	M24×500/M20×400	250	400	800	1000	1100	100	M20×400	250	75	800	1100	1200	260	19
200DL	250	500	480	750	800	100	M24×500	250	400	800	1000	1100	100	M20×400	250	75	800	1100	1200	260	19